

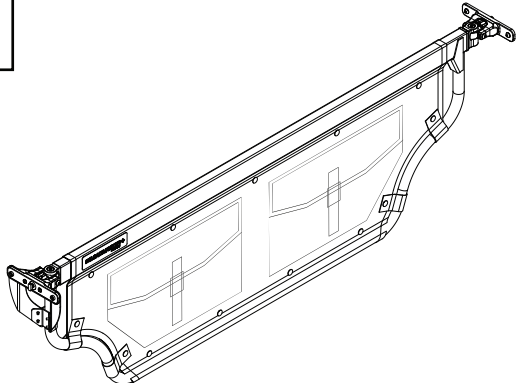
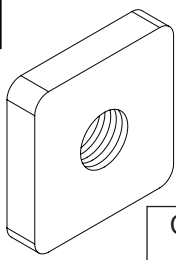
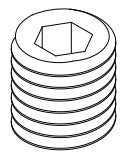

INSTALLATION INSTRUCTIONS (K422)

LOADMASTER ◆

<p>A</p>  <p>X1</p>	<p>B</p> <p>M6</p>  <p>X2</p>	<p>C</p> <p>M6</p>  <p>X2</p>
<p>COMPONENTS B & C USED ONLY WITH SPORTLID FOR TANGO</p>		

◆ = EXISTING PART
○ = NEW PART

COMPATIBLE
ONLY WITH

TANGO ◆

RAIL PROTECTION
SYSTEM

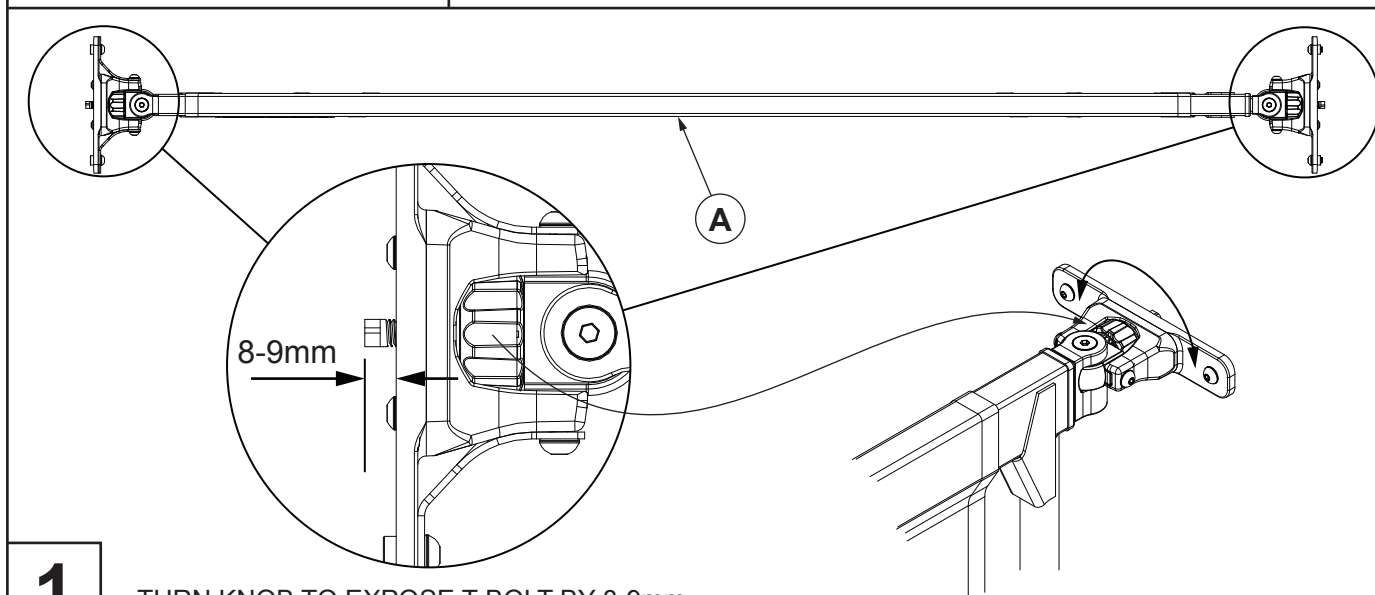

1

TURN KNOB TO EXPOSE T-BOLT BY 8-9mm

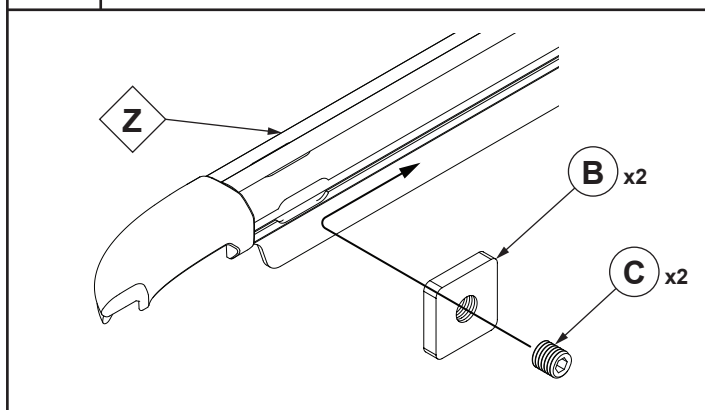

2

FOR VEHICLES WITH
SPORTLID FOR TANGO ONLY

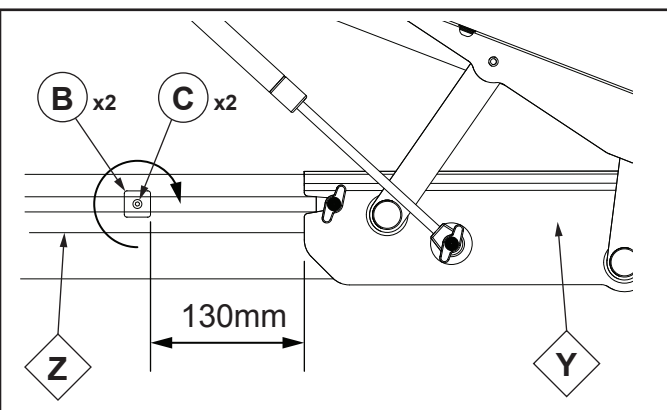

3

FOR VEHICLES WITH
SPORTLID FOR TANGO ONLY

Fitting Kit Number	Manufacturer	Model Type	Year	Stockist	Cab Size	Product	Revision	Date	Page
K422	UNIVERSAL	-	-	-	DC	LOADMASTER	4	2/03/16	1 of 2

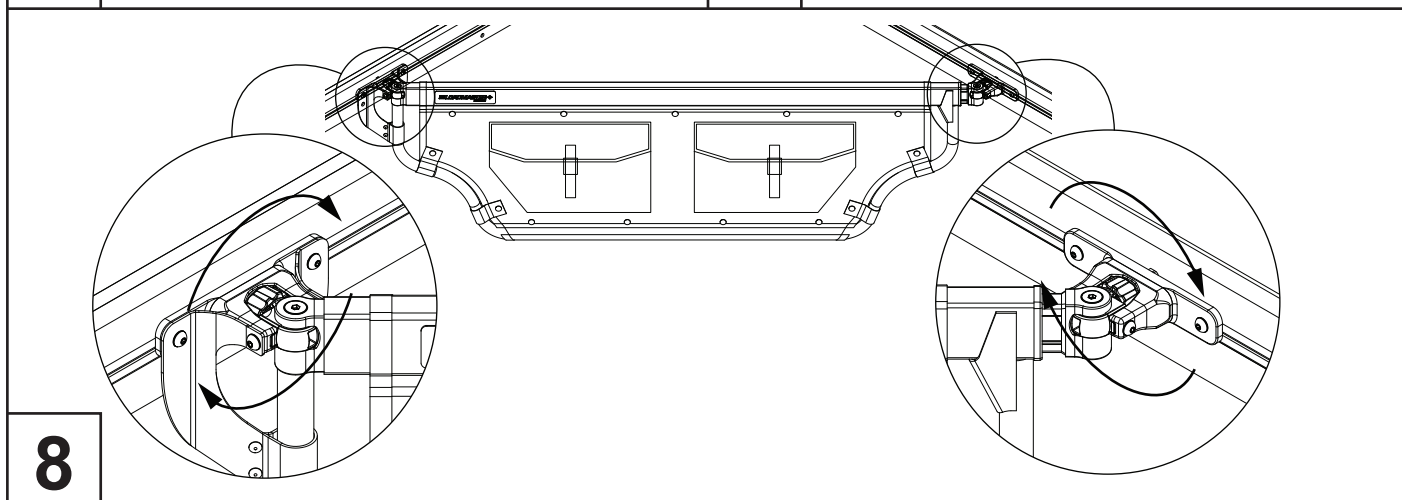
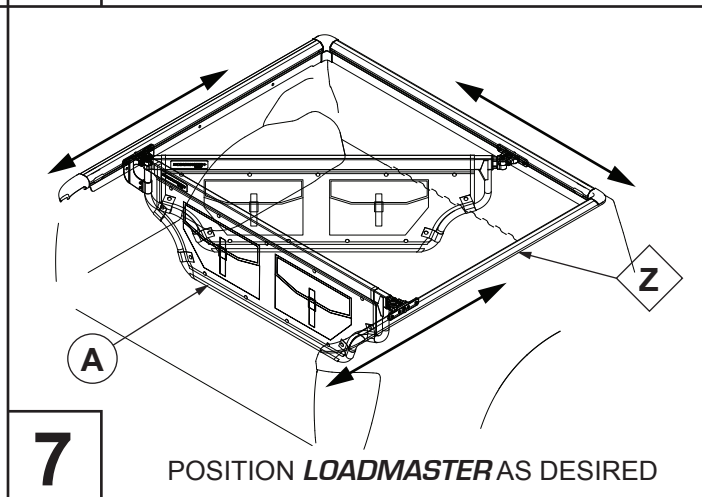
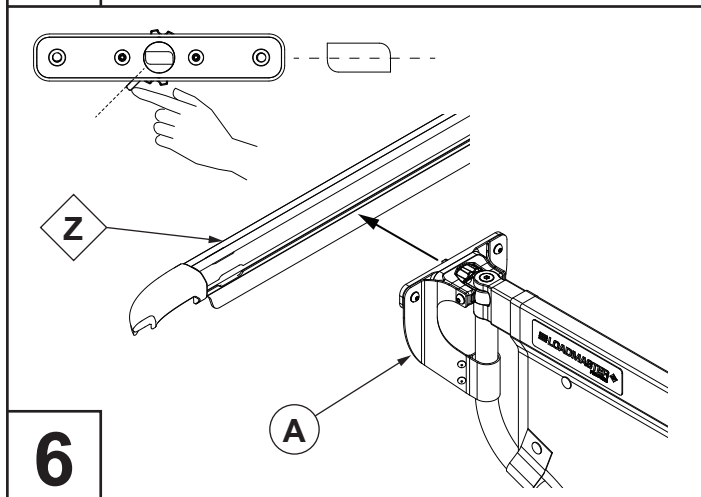
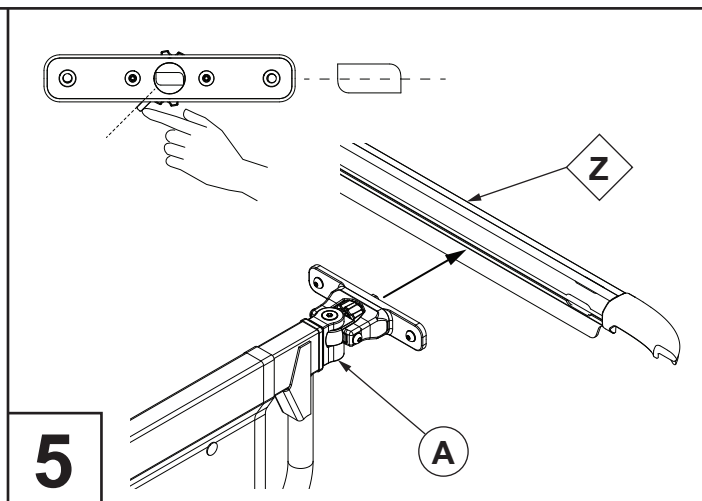
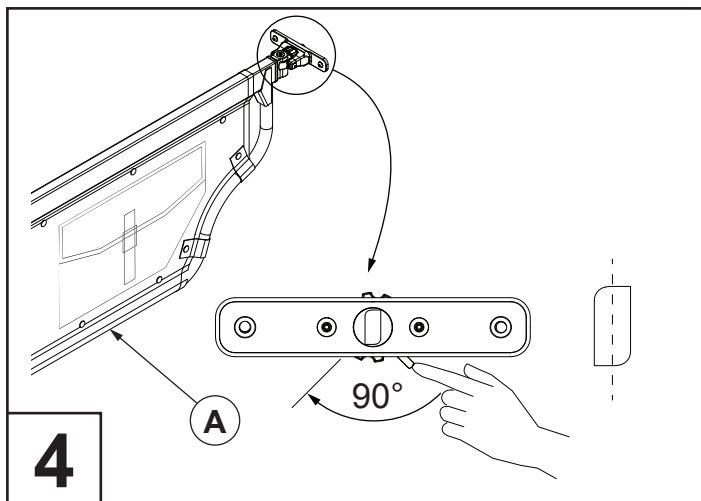

Fitting Kit Number	Manufacturer	Model Type	Year	Stockist	Cab Size	Product	Revision	Date	Page
K422	UNIVERSAL	-	-	-	DC	LOADMASTER	4	2/03/16	2 of 2