



# INSTALLATION INSTRUCTIONS (K124)

## Sportlid II with VW Genuine Polished Styling Bar

### Volkswagen-Amarok-2010-Double Cab

<b>A</b>  1X	<b>B</b>  1X	<b>C</b>  1X	<b>D</b>  1X	<b>E</b>  10X	<b>F</b>  2X	<b>G</b>  2X		
<b>H</b>  4X	<b>I</b>  2X	<b>J</b>  2X	<b>K</b>  6X	<b>L</b>  10X	<b>M</b>  14X	<b>N</b>  1X	<b>O</b>  2X	<b>P</b>  4X
<b>Q</b>  <b>POLISHED STAINLESS PART NUMBER 2H0071000B72A</b> Refer to sportbar assembly instruction. Assemble bar before lid fitment	<b>R</b>  2X		<b>S</b>  4X		<b>T</b>  4X	<b>U</b>  4X	<b>V</b>  4X	
<b>W</b> Clear Tape 35X50MM  2X	<b>Z</b> Sportlid Badge  1X		<p><b>Note 1:</b> If at any stage of installation you find your sportlid to be an unacceptable fit please contact the manufacturer before continuing.</p> <p><b>Note 2:</b> If required, use Under Rail Bed Liner only. Not for use with Over Rail Bed Liner</p> <p><b>Tools Required:</b> 5mm Allen Key</p>					

**! RAIN SEAL MUST BE APPLIED AFTER PAINT PROCESS IS COMPLETE DO NOT APPLY BELOW 15°C DO NOT stretch when applying. Apply pressure to seal. Adhesive is pressure activated. Allow 3hrs minimum to cure before fitting lid.**

**INSTALLATION TIME APPROX: 30 Minutes**

○ = NEW PART

**1** ○ A ○ N

Use roller to apply pressure

Fitting Kit Number	Manufacturer	Model Type	Year	Stocklist	Cab Size	Product	Revision	Date	Page
IDFK124	Volkswagen	Amarok	2010		DC	Sportlid II	11	22-03-16	1 of 5

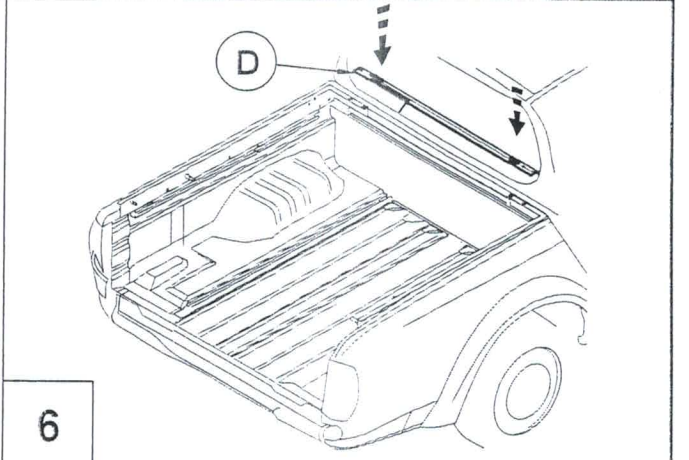
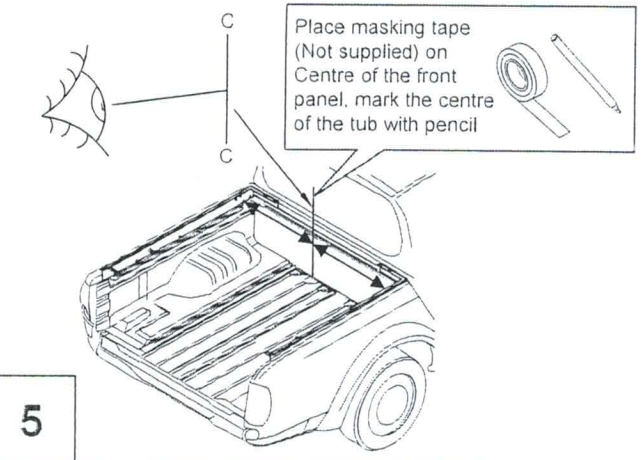
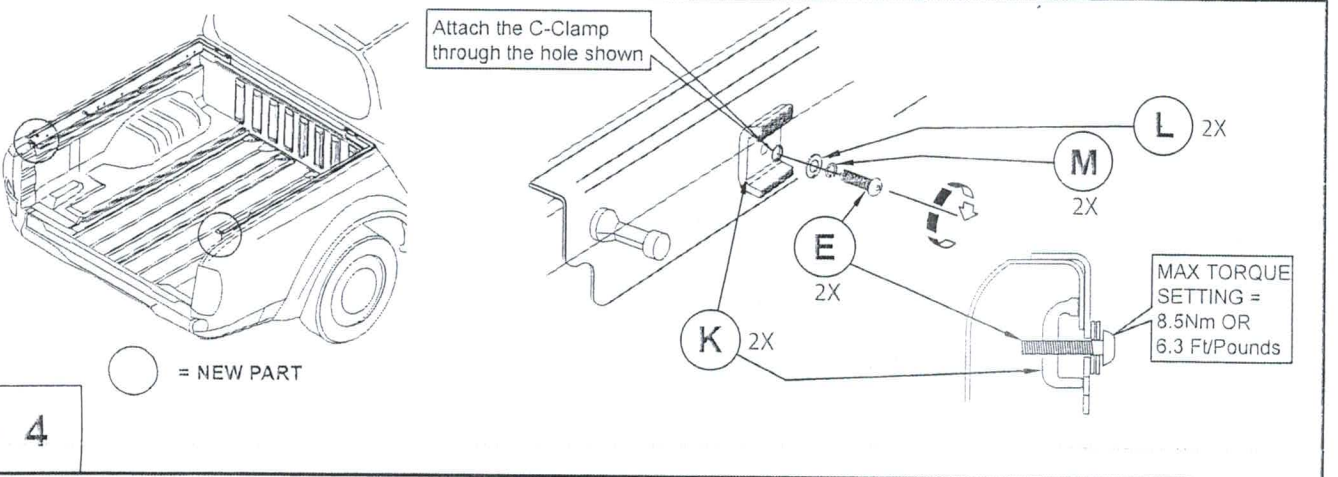
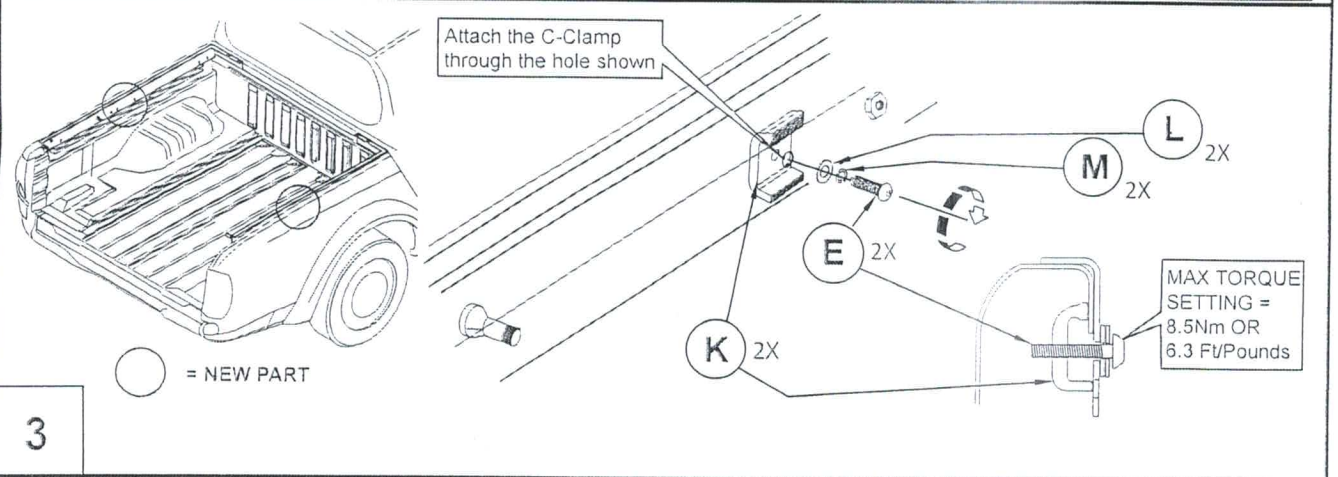
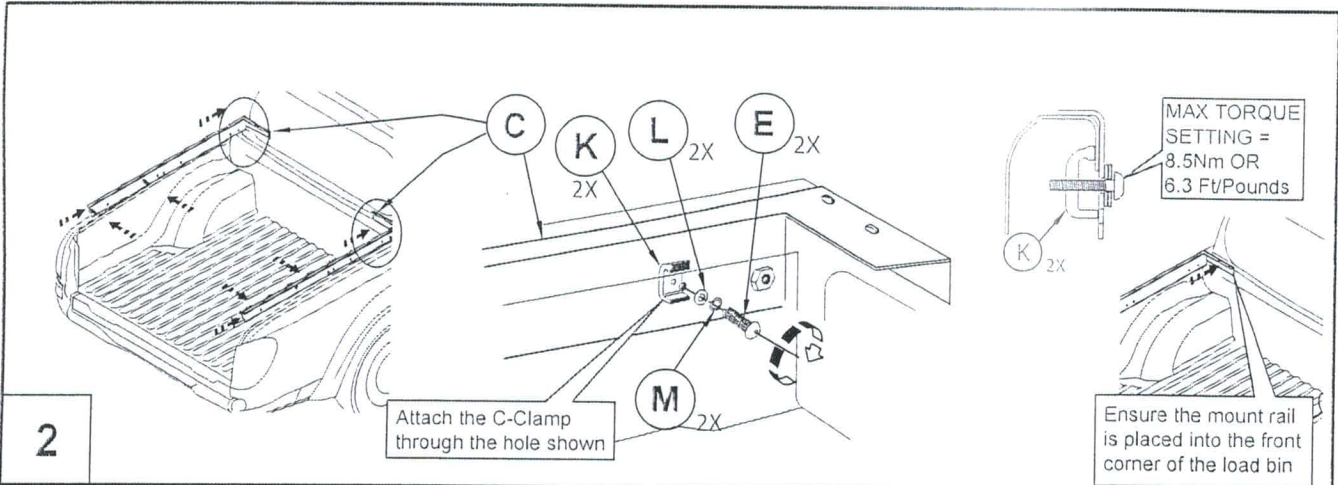

Fitting Kit Number	Manufacturer	Model Type	Year	Stocklist	Cab Size	Product	Revision	Date	Page
IDFK124	Volkswagen	Amarok	2010		DC	Sportlid II	11	22-03-16	2 of 5

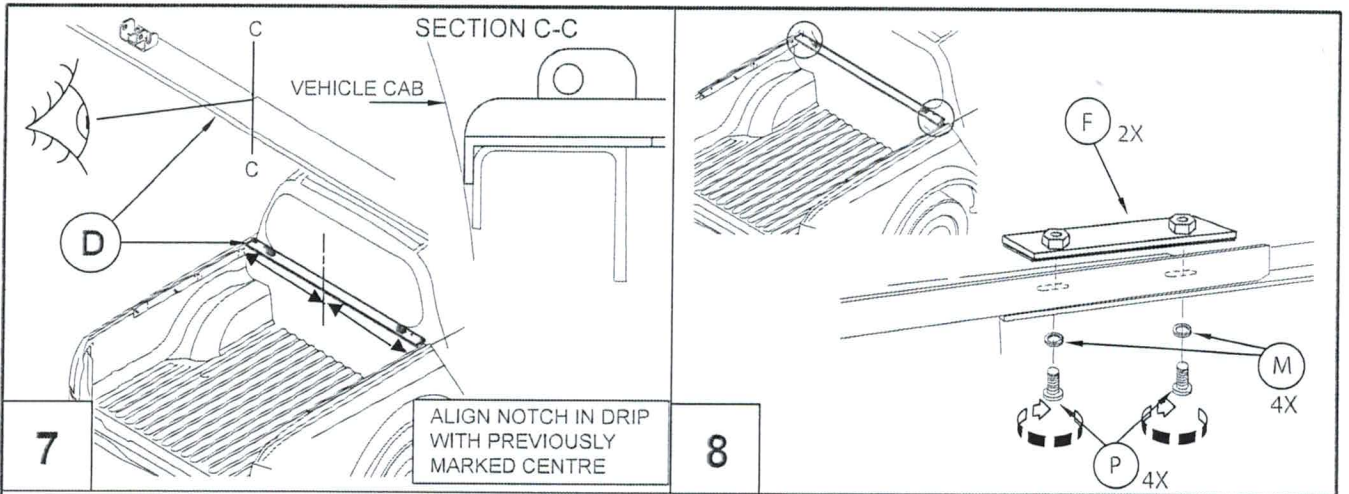

○ = NEW PART    □ = 2H0071000B72A

REFER TO SPORTSBAR INSTALLATION INSTRUCTIONS FOR SPORTS BAR ASSEMBLY

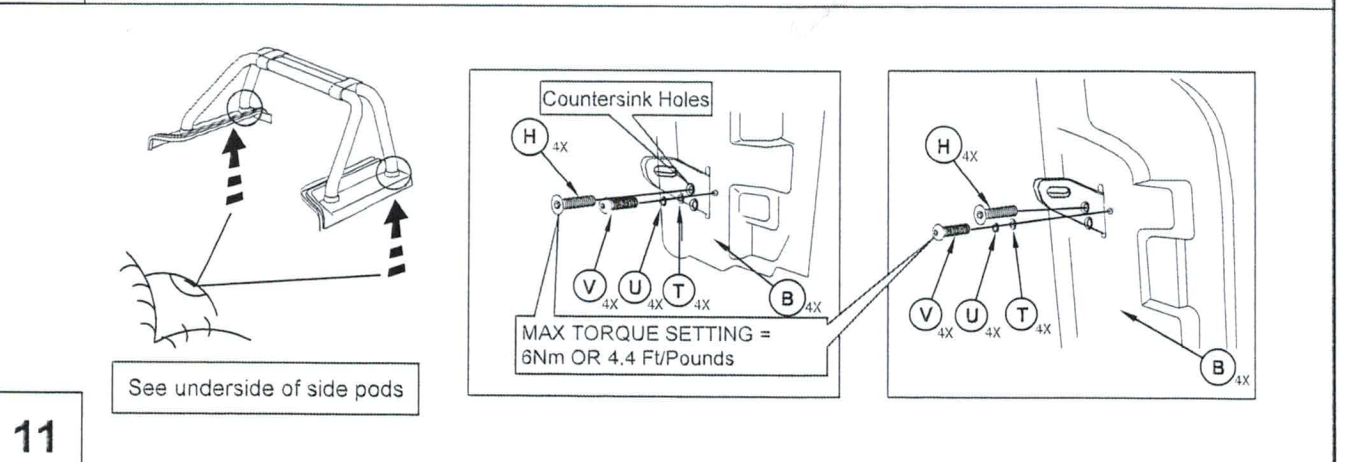
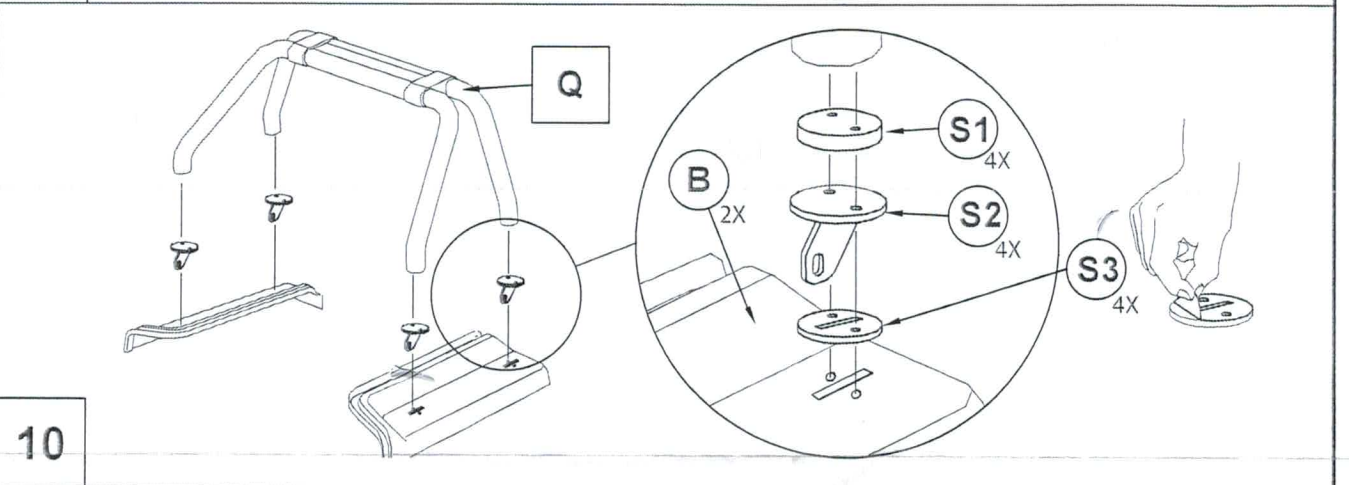
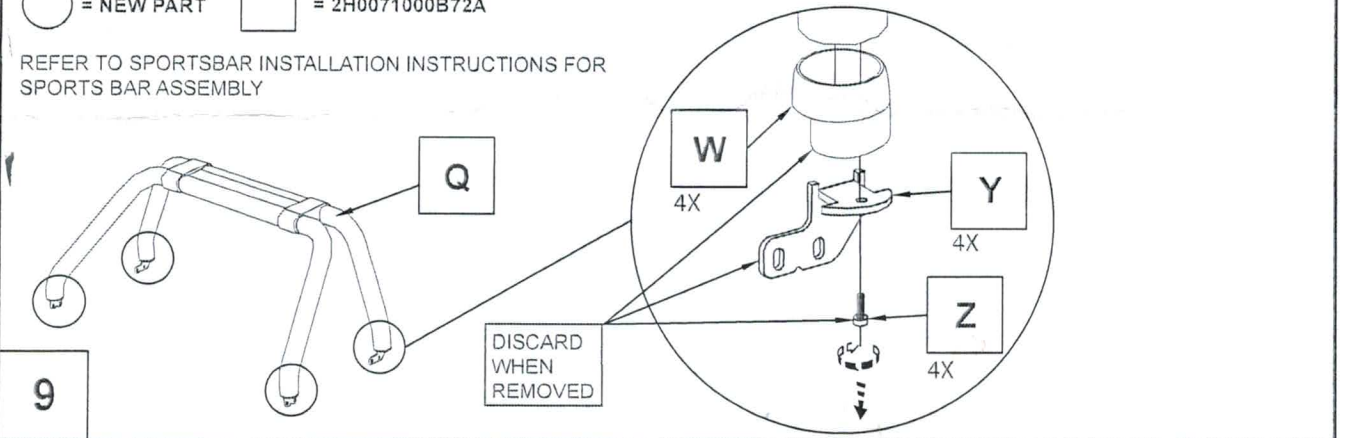

Fitting Kit Number	Manufacturer	Model Type	Year	Stocklist	Cab Size	Product	Revision	Date	Page
IDFK124	Volkswagen	Amarok	2010		DC	Sportlid II	11	22-03-16	3 of 5

12

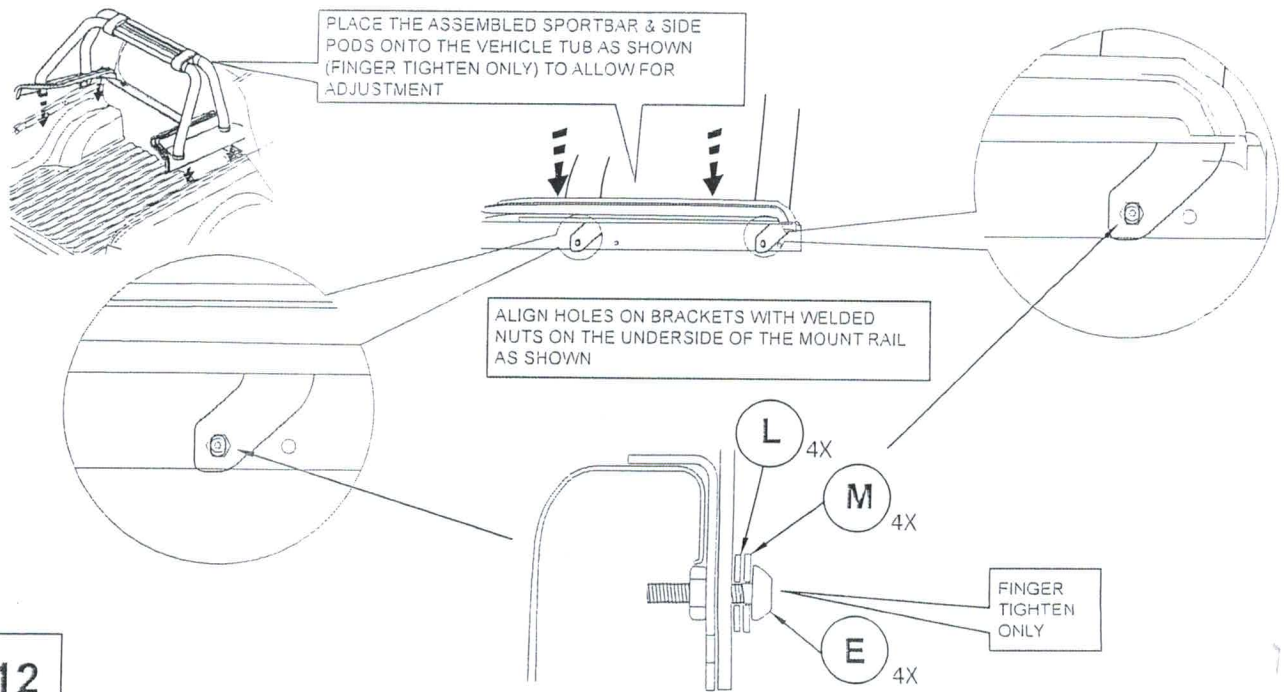

13

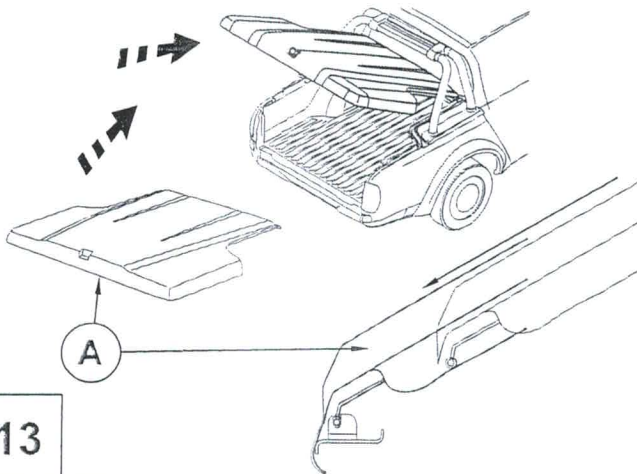

14

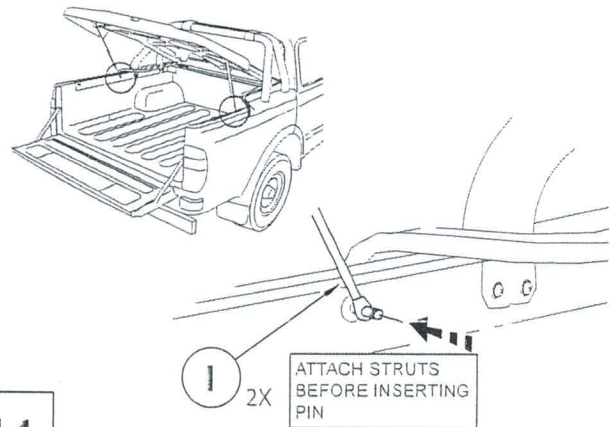

15

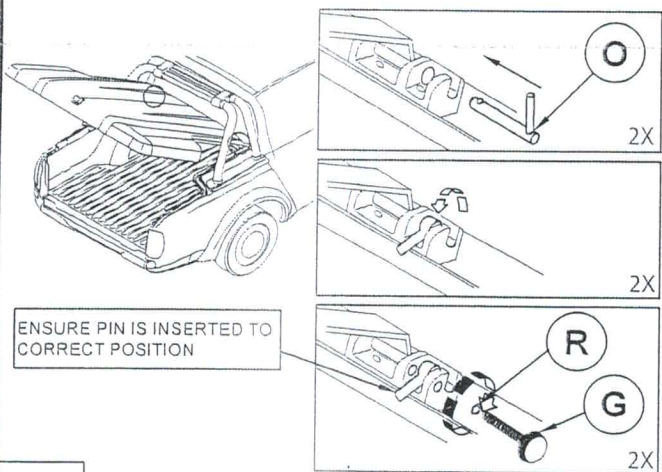

16

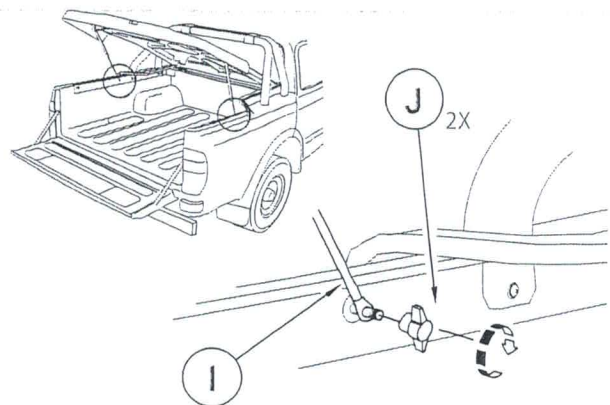

Fitting Kit Number	Manufacturer	Model Type	Year	Stocklist	Cab Size	Product	Revision	Date	Page
IDFK124	Volkswagen	Amarok	2010		DC	Sportlid II	11	22-03-16	4 of 5

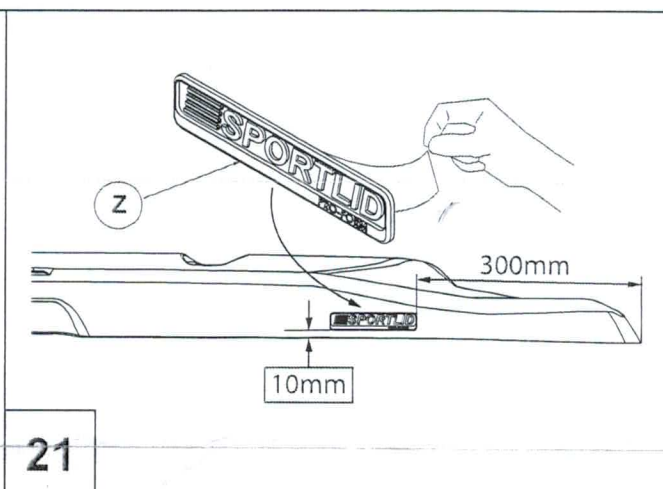
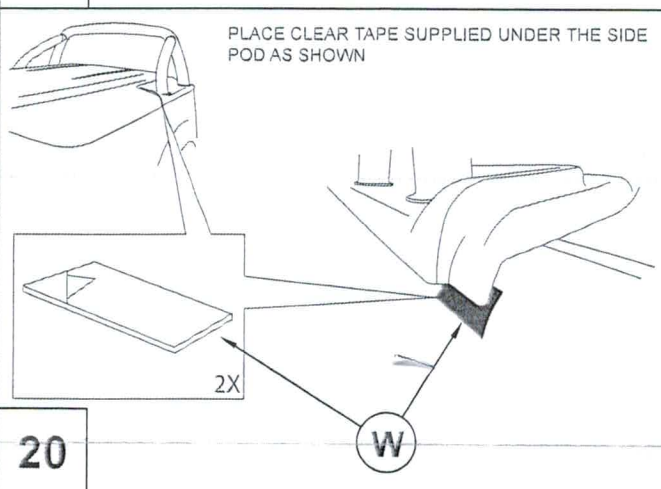
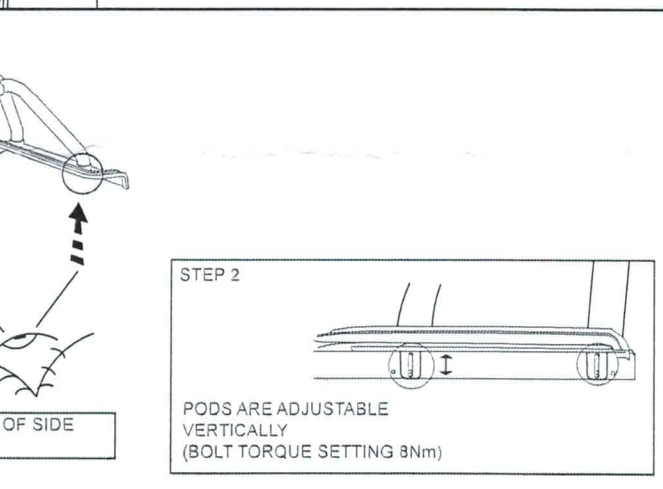
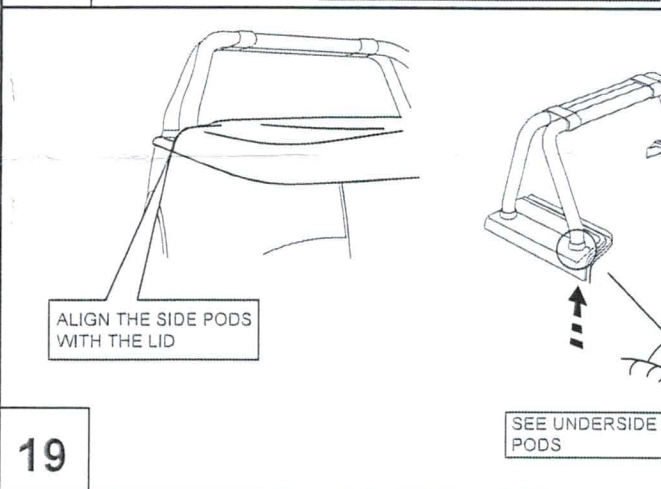
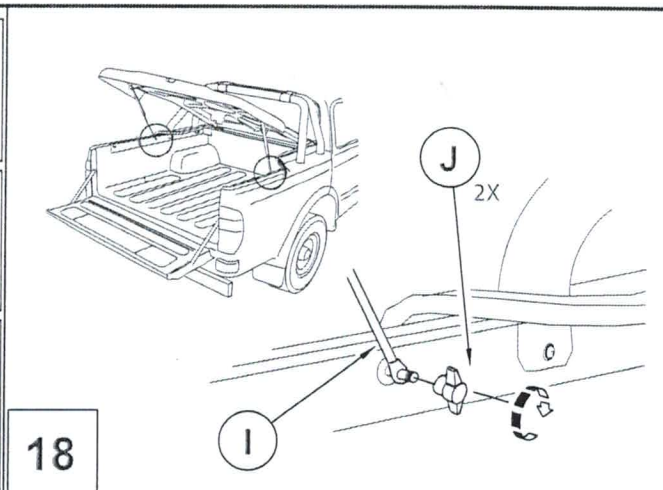
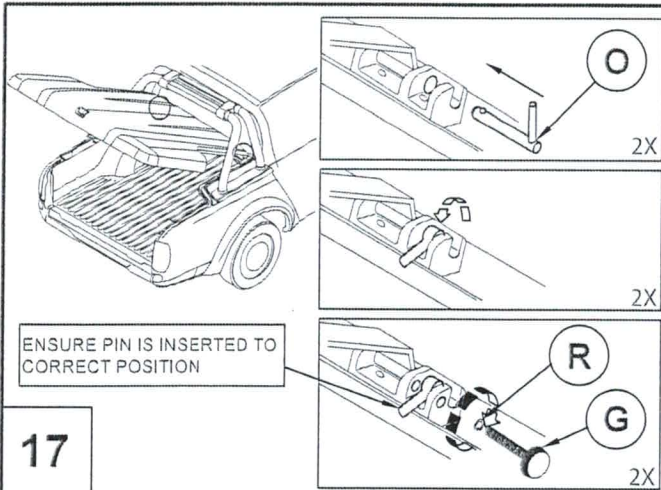

AFTER THE DESIRED ALIGNMENT IS ACHIEVED, TIGHTEN ALL BOLTS TO THE REQUIRED TORQUE SETTINGS AS STATED IN THE INSTRUCTIONS

Fitting Kit Number	Manufacturer	Model Type	Year	Stocklist	Cab Size	Product	Revision	Date	Page
IDFK124	Volkswagen	Amarok	2010		DC	Sportlid II	11	22-03-16	5 of 5