

Page 3-5

Page 6-8

* needs to be ordered separately



MONTAGEANLEITUNG ASSEMBLING INSTRUCTIONS

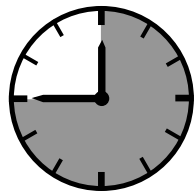

45 Minuten

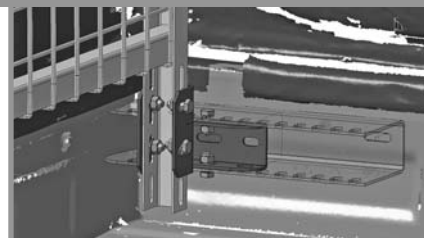

LOAD BAR 60 FRONT / TRAGBÜGEL 60 VORN
VW AMAROK – Artikel-Nr: 13H 5466 Steel black • 13H9227 Mounting Set –

Dr. Höhn GmbH
Künzelsauer Str. 13
D-74653 Ingelfingen

Phone: +49 (0) 7940 / 920241-42
Fax: +49 (0) 7940 / 920245

E-Mail: roadranger@hoehn.de
www.hoehn.de

Parts list/Teileliste/Lista de accesorios

1 13H5466.1 R / 13H5466.2 L

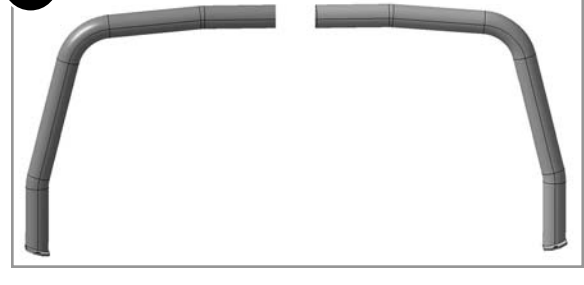

Mounting set 13H9227 / Montagesatz 13H9227

2 Ø60; 10V 5146



3 13H5123 R / 13H5124 L



4 10V 8045 2x

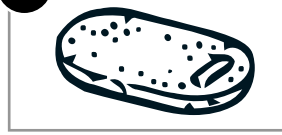

not included:

- Mounting Set 13R9266 -

6 13R5192 R / 13R5193 L

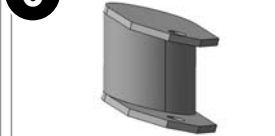

not included:
- separate -

5 52 11 04- 10 4x

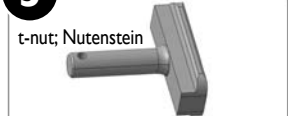

S		M10x25; DIN 933	2x
t		Ø10; DIN 127	2x
U		Ø10,5; DIN 125	4x
V		M10; DIN 934	2x
X		SW 17	2x

Standard Parts list/Normteileliste

a		M6x25; DIN 933 A2	3x
b		Gefu-2 Schraube M5 x 16	8x
c		M8x30; DIN 933	8x
d		M10x40; DIN 933	2x
e		M6; DIN 985 A2	3x
f		M10; DIN 985	2x
g		M8; DIN 934	8x
h		Ø8; DIN 127	8x
i		Ø 6,4; DIN 125 A2	6x
j		Ø 8,4; DIN 9021	16x
k		Ø 10,5; DIN 125	2x
m		Ø 10,5; DIN 9021	2x
n		SW 13mm	4x
o		SW 17mm	2x
p		Ø 4	1x



benötigte Werkzeuge

ASSEMBLY INSTRUCTIONS: REQUIRED TOOLS

SW: 8mm
SW: 10mm
SW: 13mm
SW: 17mm

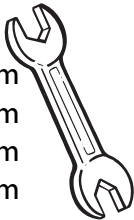

Ø 11 mm
Ø 4mm

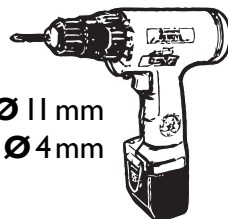

M5: 6 Nm
M6 (A2): 8,8 Nm
M8: 25 Nm
M10: 50 Nm

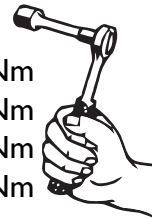

LOAD BAR 60 FRONT / TRAGBÜGEL 60 VORN
VW AMAROK – Artikel-Nr: 13H 5466 Steel black • 13H9227 Mounting Set –

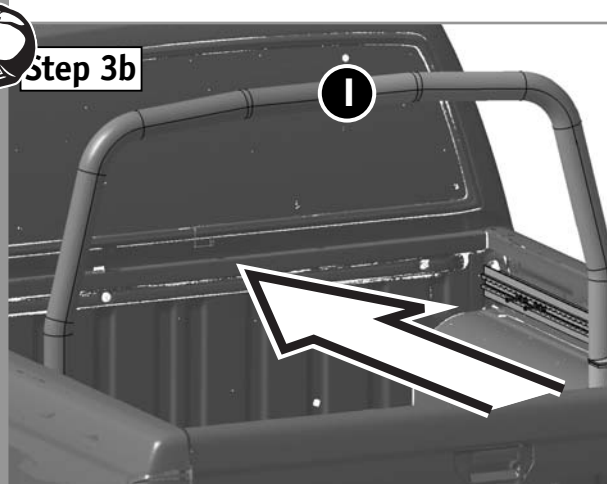
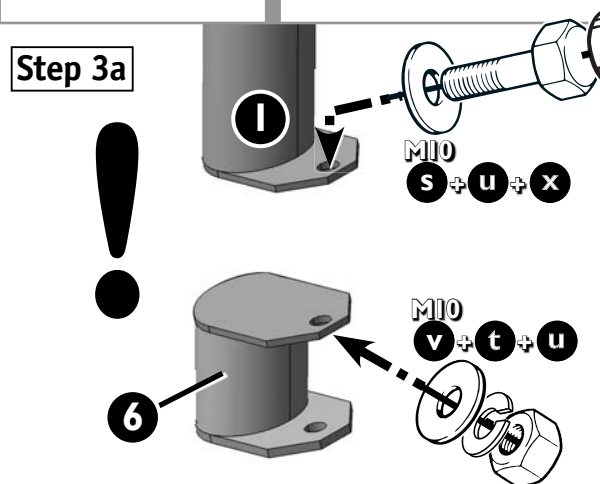
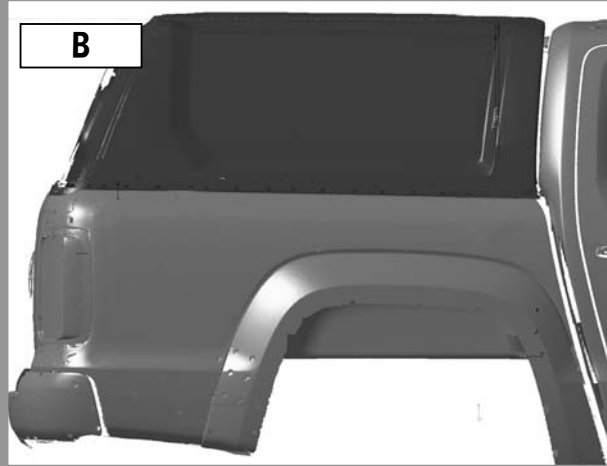
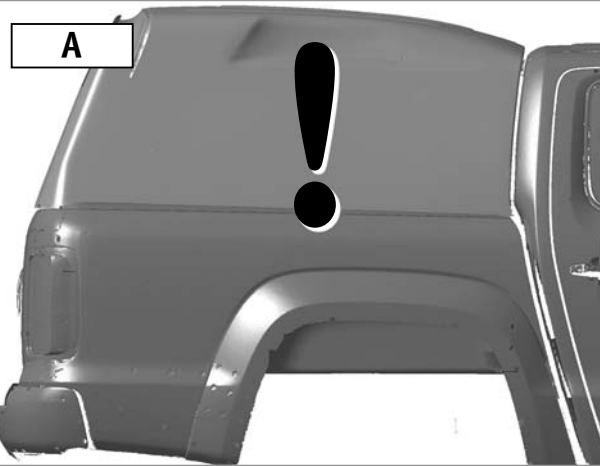
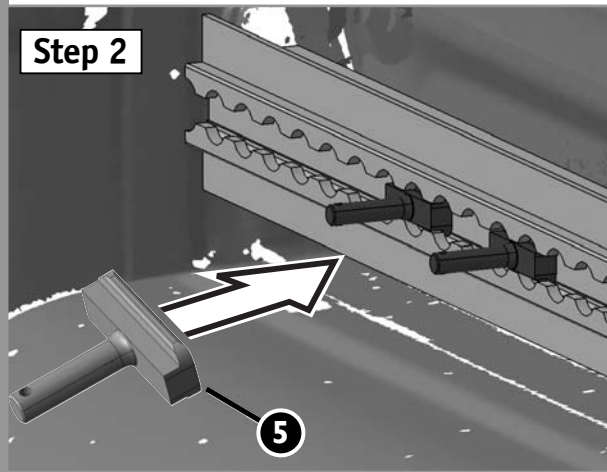
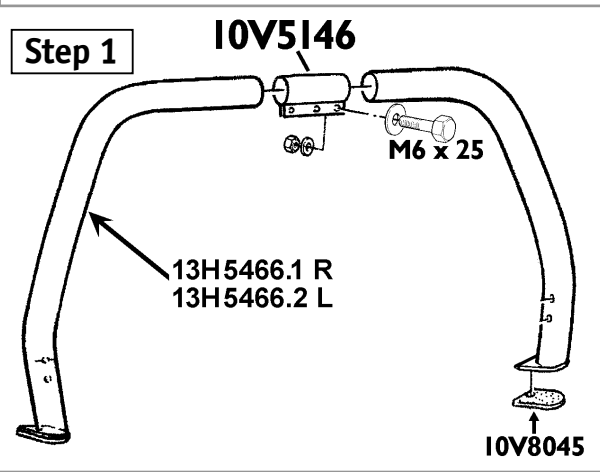
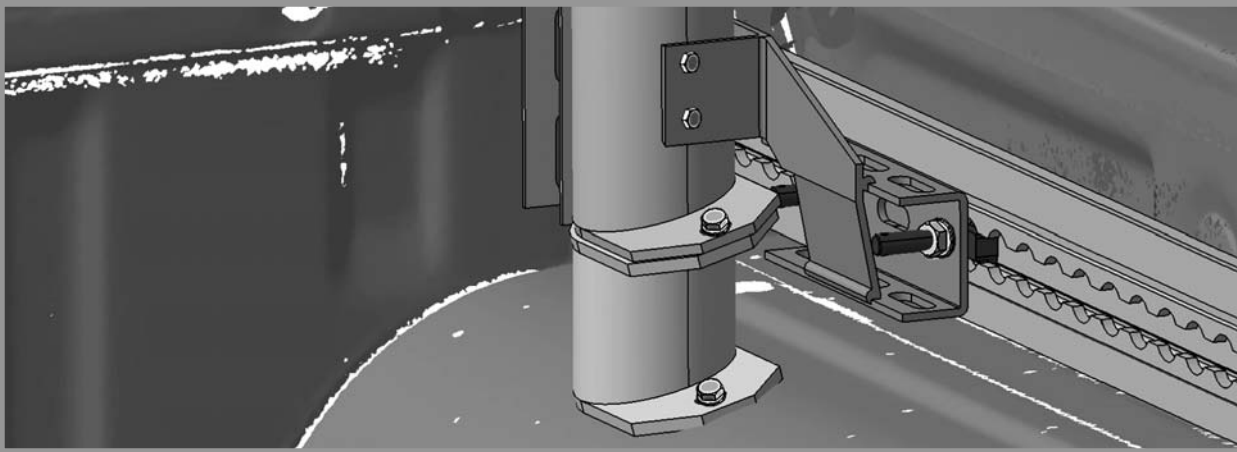

Artikel-Nr:
13H 5466 Steel black

Revision 2: 25.05.2011

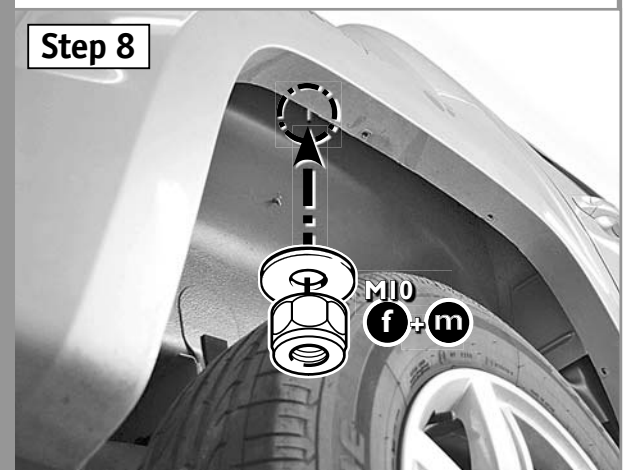
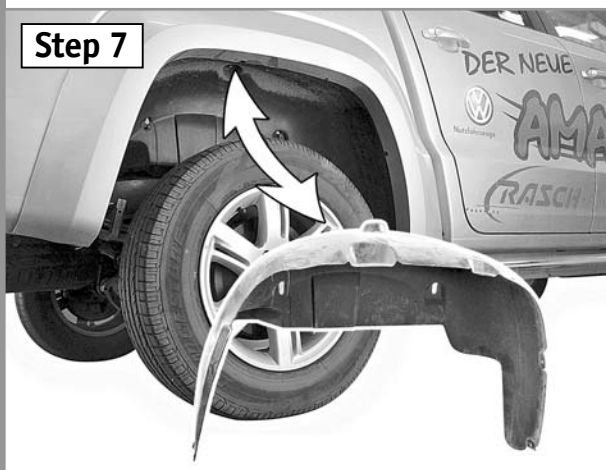
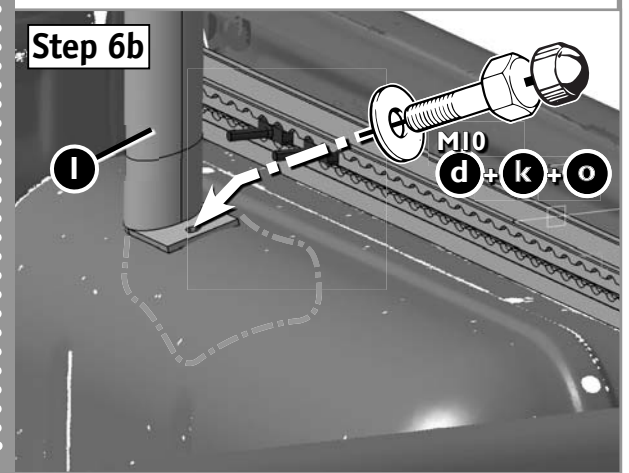
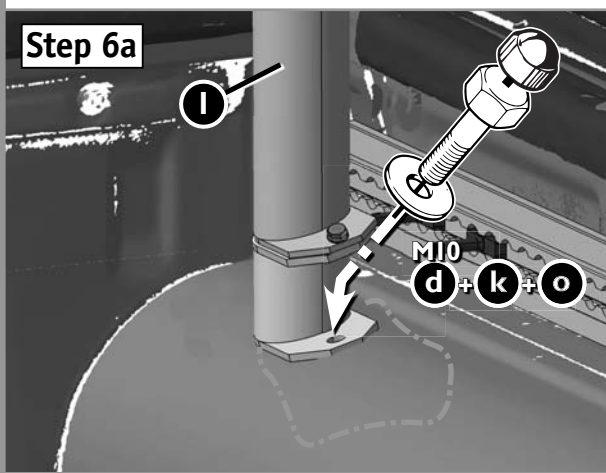
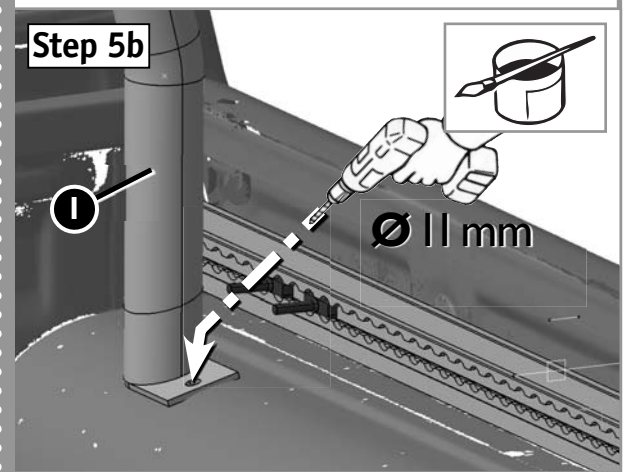
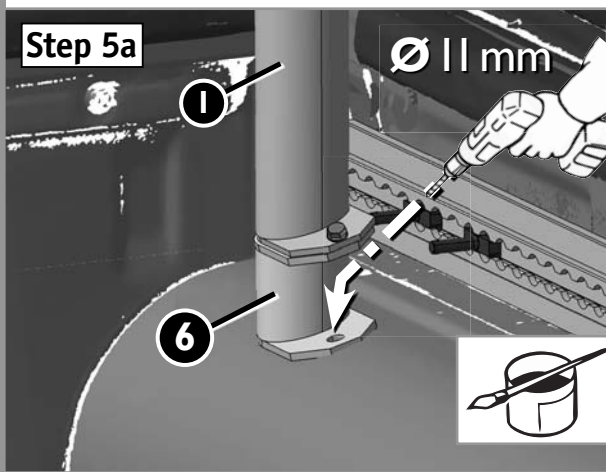
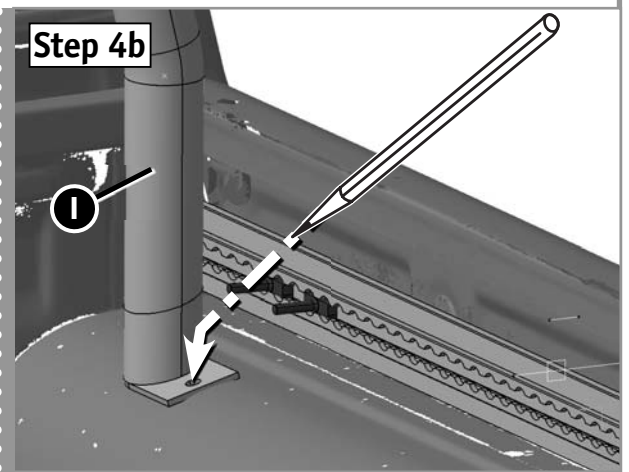
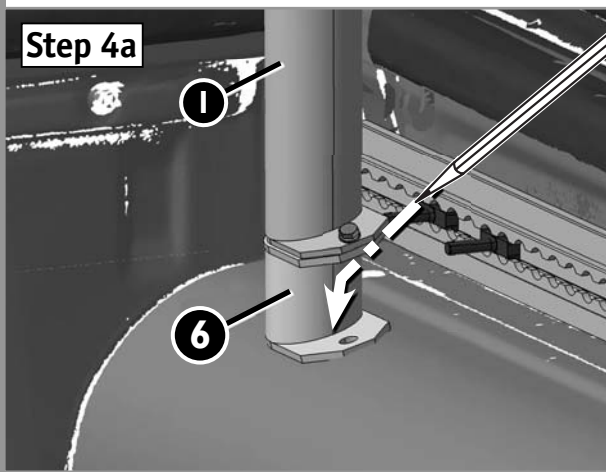

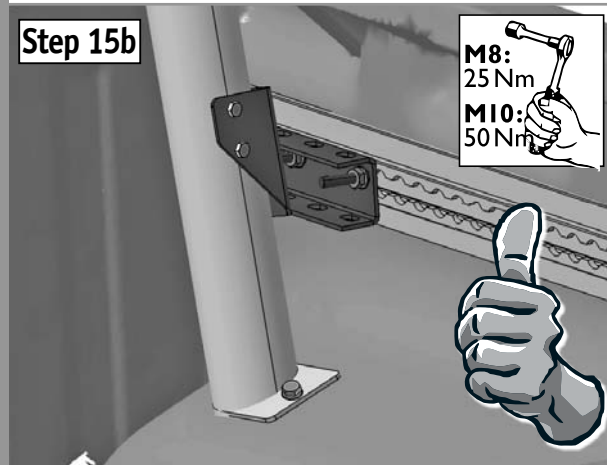
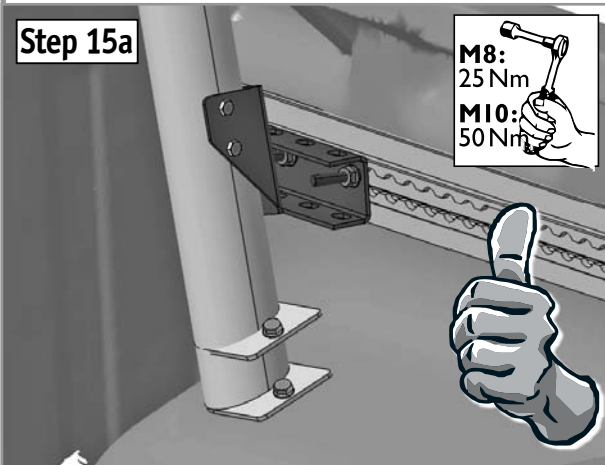
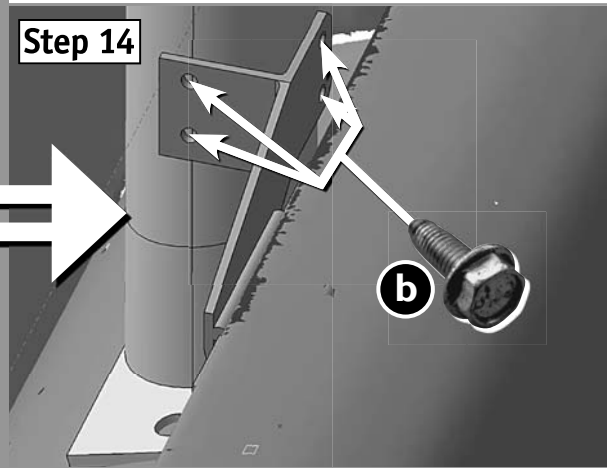
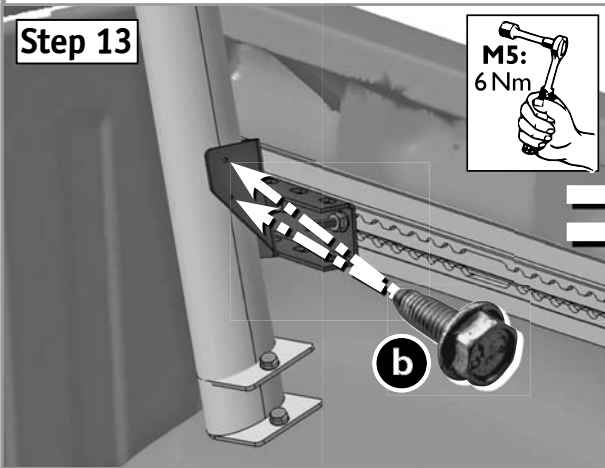
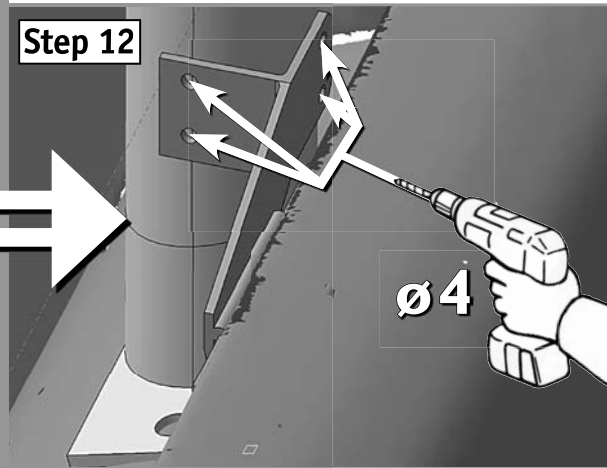
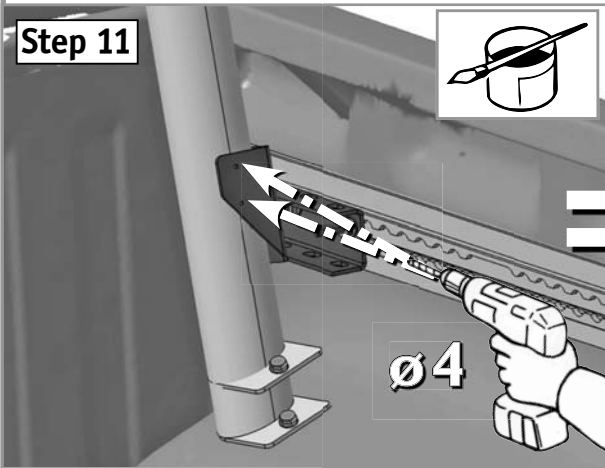
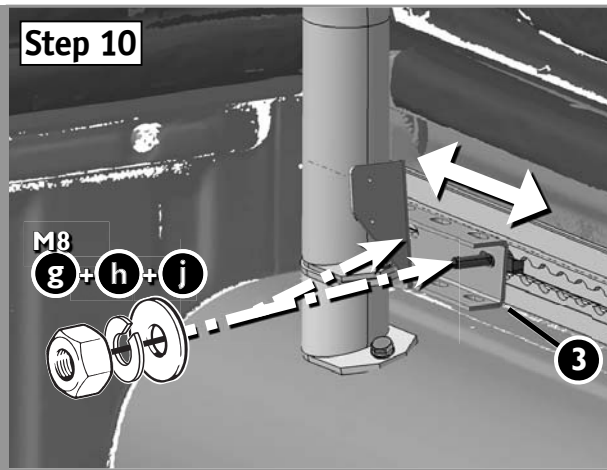
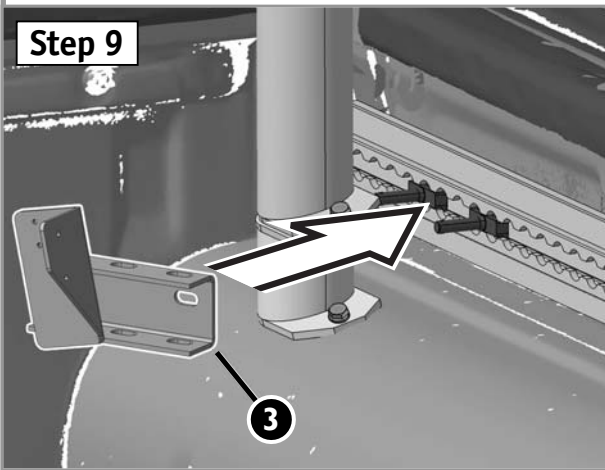

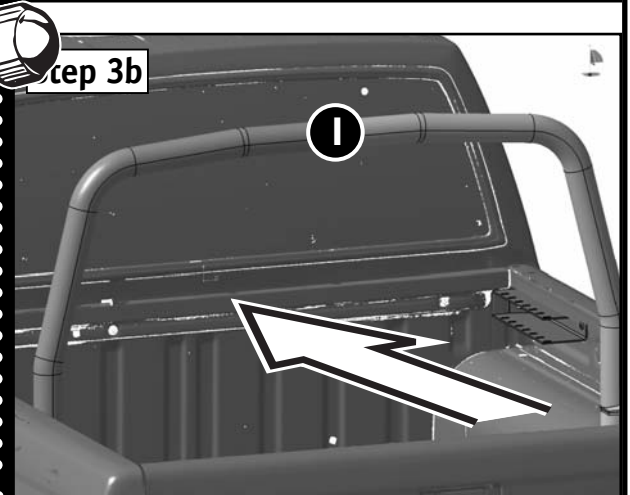
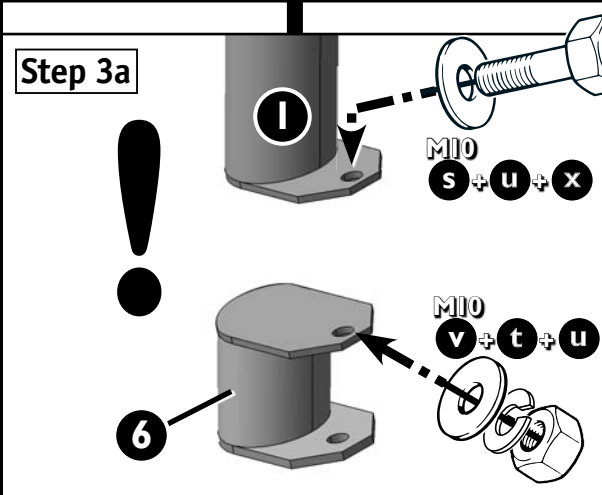
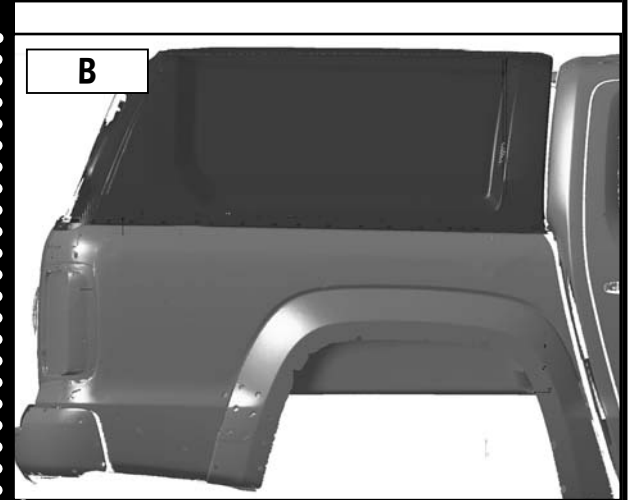
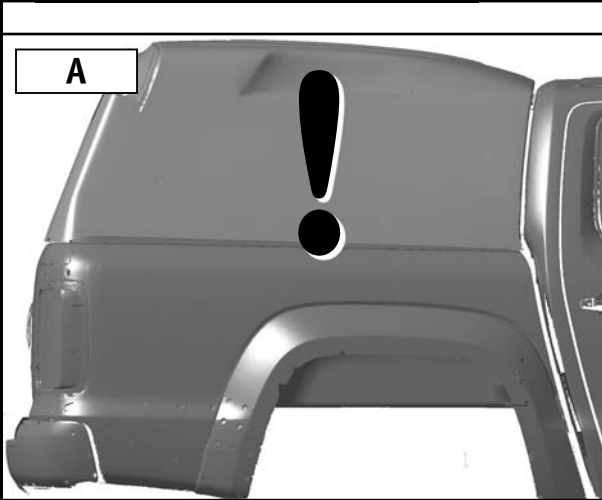
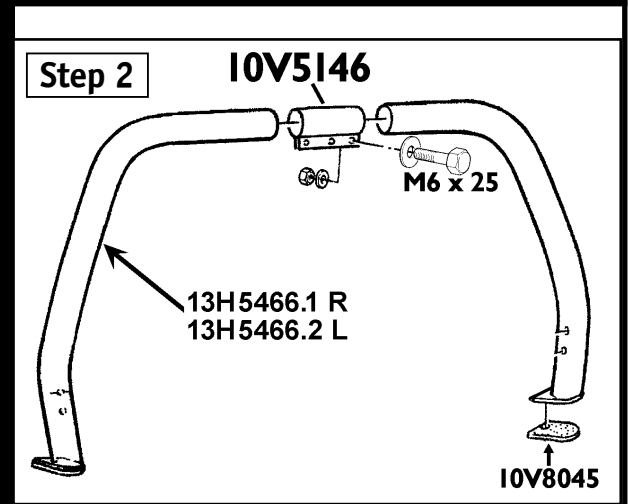
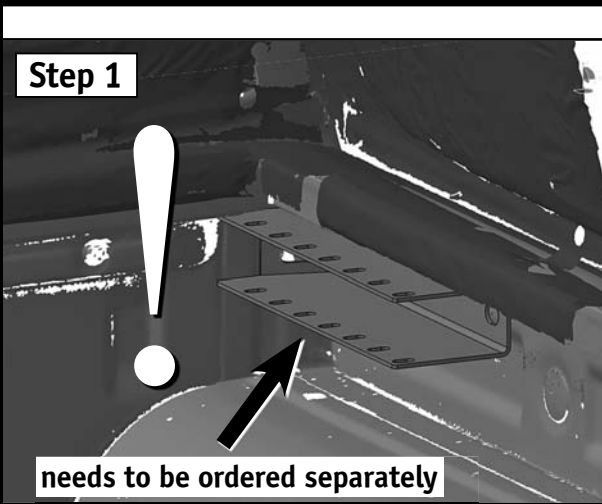
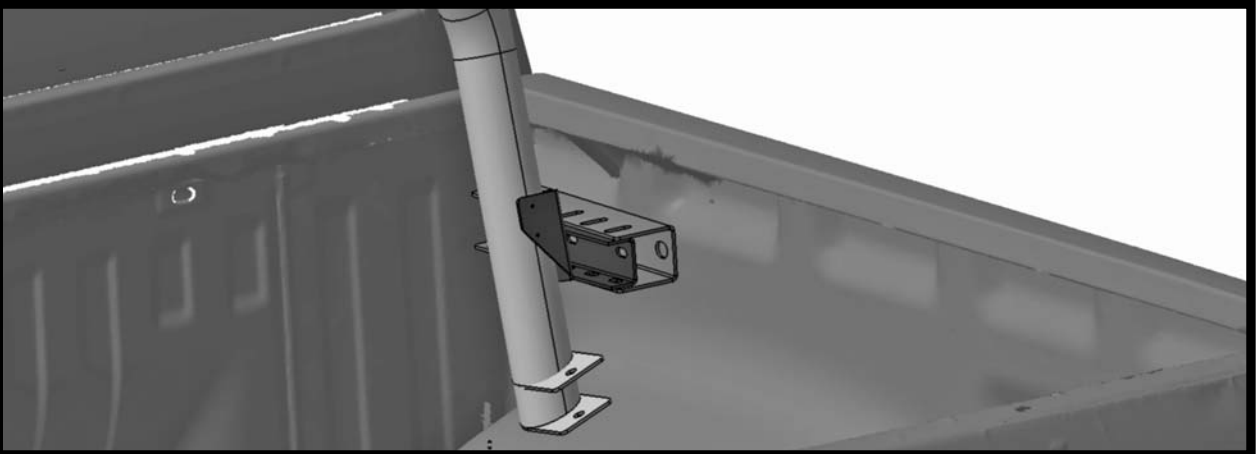

Step 4a

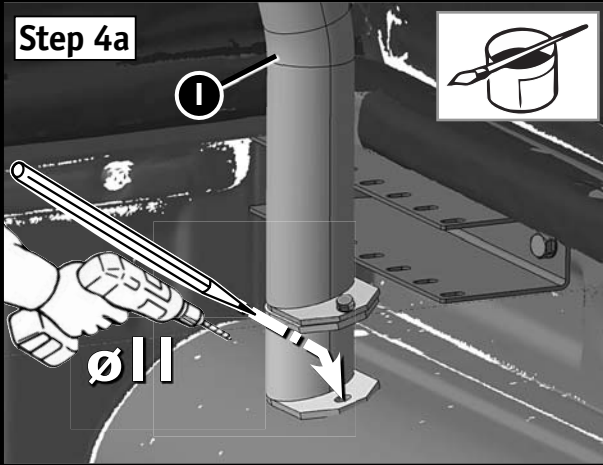

Step 4b

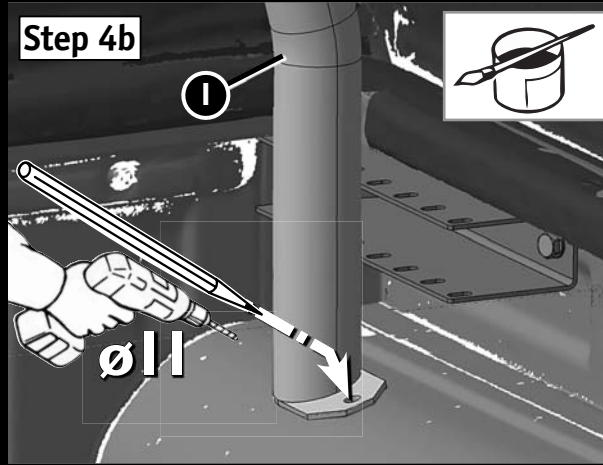

Step 5a

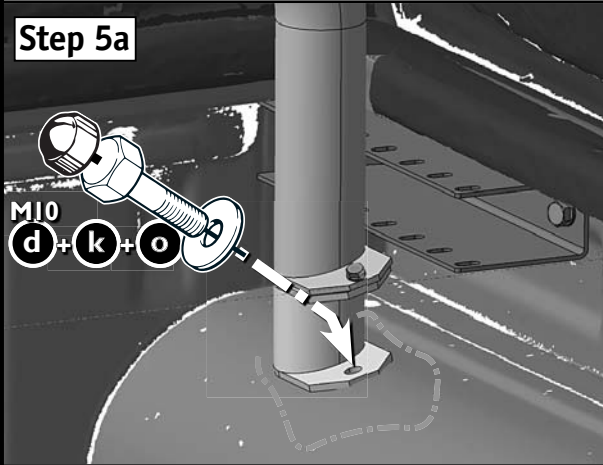

Step 5b

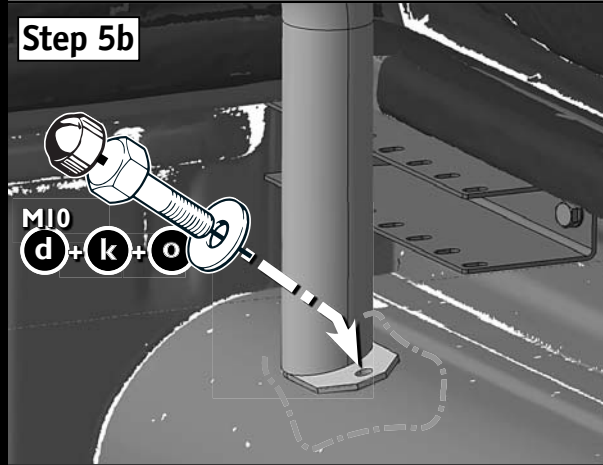

Step 6

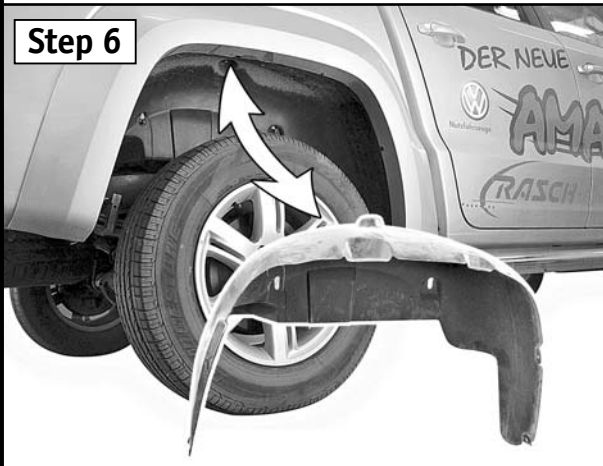

Step 7

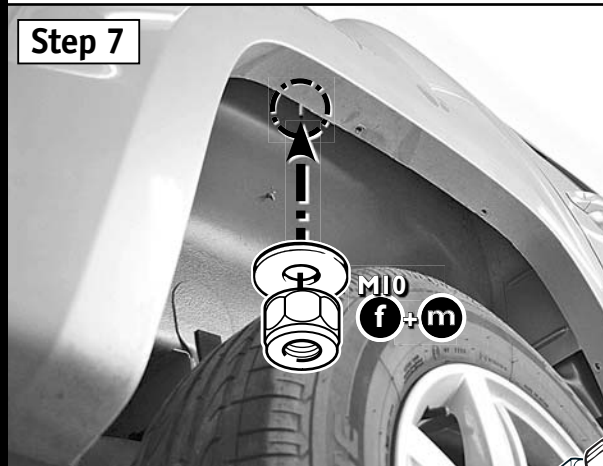

Step 8

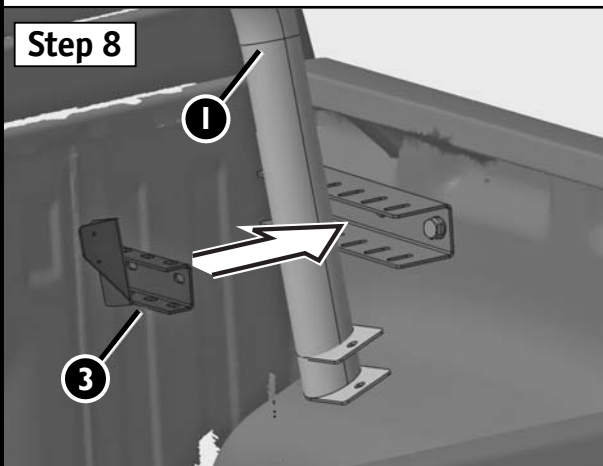

Step 9

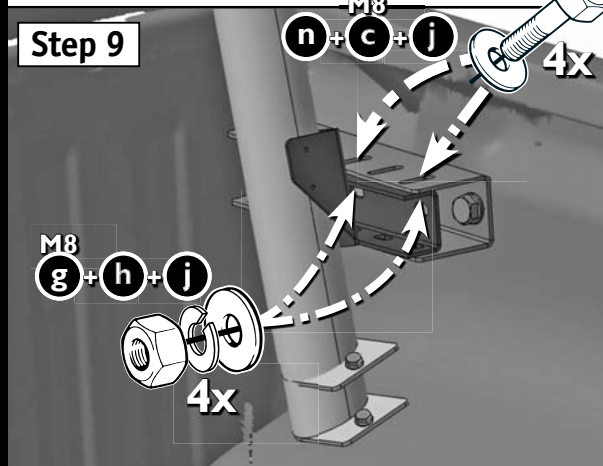

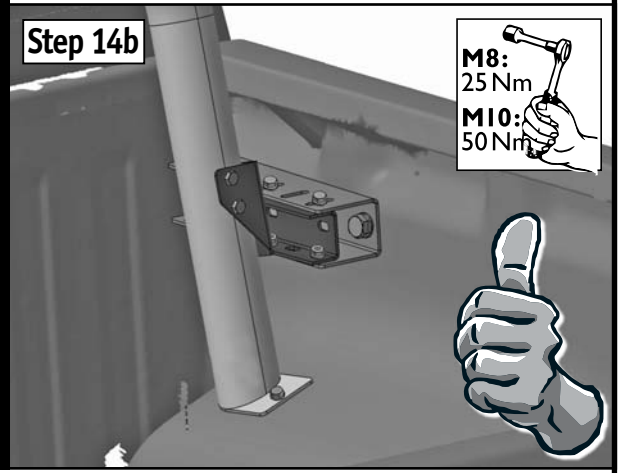
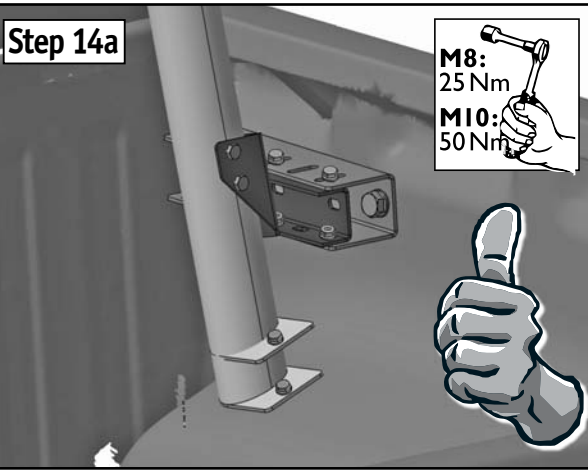
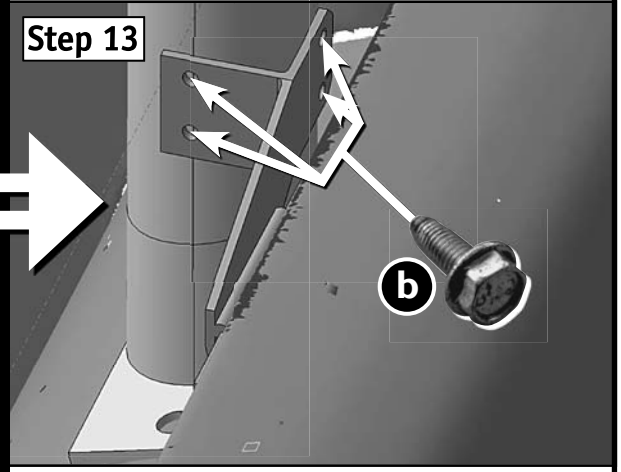
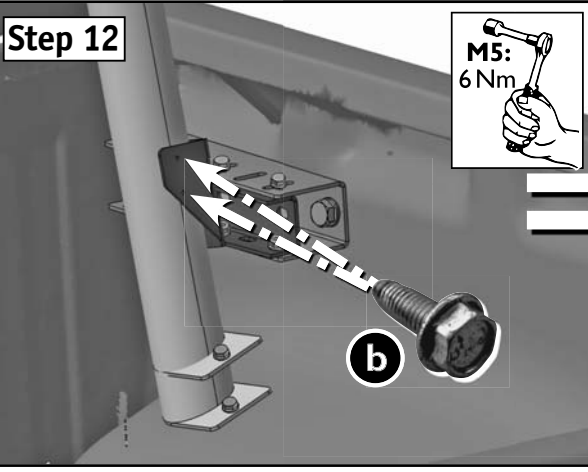
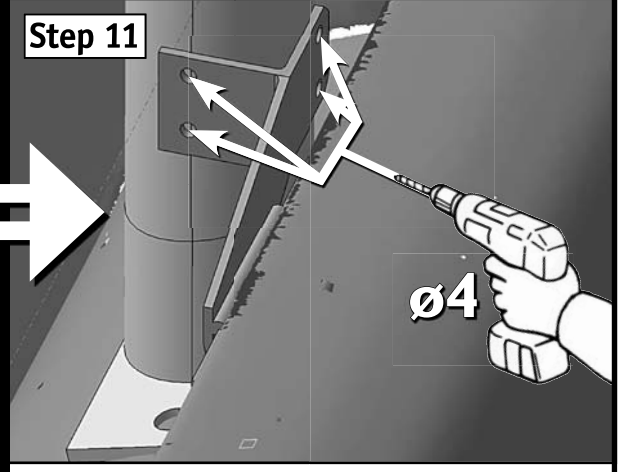
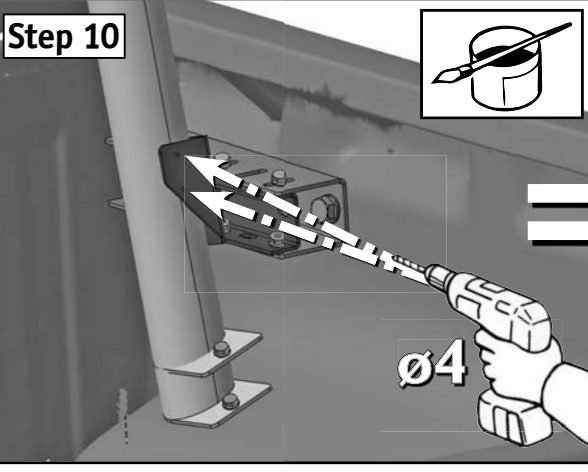



MONTAGEANLEITUNG

ASSEMBLING INSTRUCTIONS



page 1-5ff.

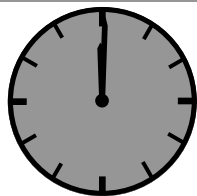

60 Minuten



page 6ff.

REAR LOAD BAR 60 / LASTENTRÄGER 60 HINTEN

- Artikel-Nr: 13H5566 Steel black • Mounting Set: 13H9228 Steel black

Dr. Höhn GmbH
Künzelsauer Str. 13
D-74653 Ingelfingen

Phone: +49 (0) 79 40 / 92 02 41-42
Fax: +49 (0) 79 40 / 92 02 45

E-Mail: roadranger@hoehn.de
www.hoehn.de

Parts list/Teileliste/Lista de accesorios

1 13H5566.1 R / 13H5566.2 L

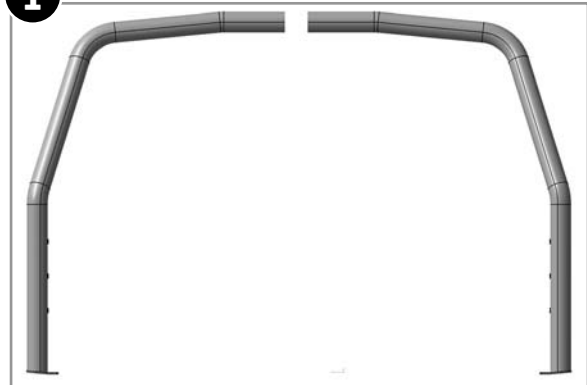

Assembly-kit 13H9228/ Montagesatz 13H9228

2 13H5126 R / 13H5127 L

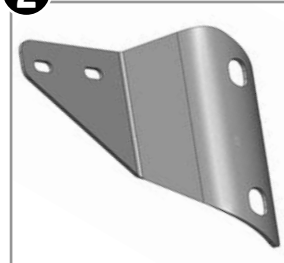

3 ø60; 10V 5146



4 10V 8045 2x



not included: adapter set 13H5470

5 13H5128 2x



6 M8; 180 5056 2x



7 00 5640



8 00 5573



9 M8x40; DIN 933 Zn



Standard Parts list/Normteileliste

a		M6x20; DIN 933 A2	3x
b		M8x30; DIN 933	4x
c		M10x40; DIN 933	2x
d		M6; DIN 985 A2	3x
e		M8; DIN 934	4x
f		M10; DIN 985	2x
g		ø8; DIN 127	8x
h		ø 6,4; DIN 125 A2	6x
i		ø 8,4; DIN 9021	8x
k		ø 10,5; DIN 9021	2x
l		ø 10,5; DIN 125	2x
m		SW 13mm	8x
n		SW 17mm	2x

Assembly-kit 13H9224

Montagesatz 13H9224 - not included -

10 13H5224



2x

o		M10x25; DIN 933	2x
p		ø10; DIN 127	2x
q		ø10,5; DIN 125	4x
r		M10; DIN 934	2x
s		SW 17	2x

DR.HÖHN

The formula for driving pleasure

not included/nicht enthalten

521104-10; T-Nut



4x



benötigte Werkzeuge

ASSEMBLING INSTRUCTIONS: REQUIRED TOOLS



SW: 10 mm
SW: 13 mm
SW: 17 mm

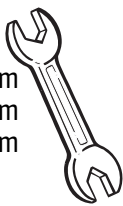

M6 (A2): 8,8 Nm
M8: 25 Nm
M10: 50 Nm

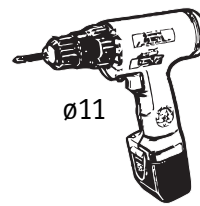

ø11

REAR LOAD BAR 60 / LASTENTRÄGER 60 HINTEN

Artikel-Nr:

13H 5566 Steel black

Revision 2: 30.3.2011

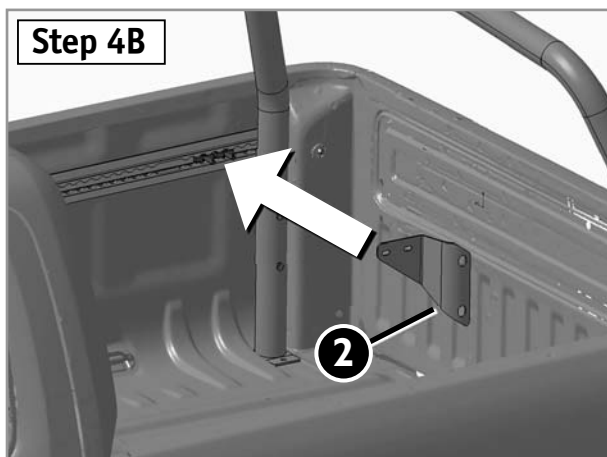
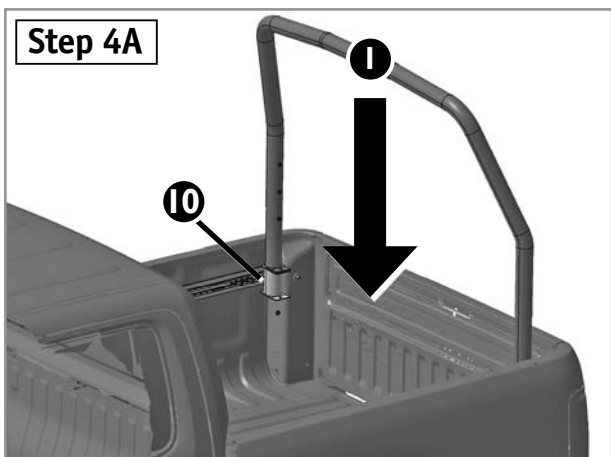
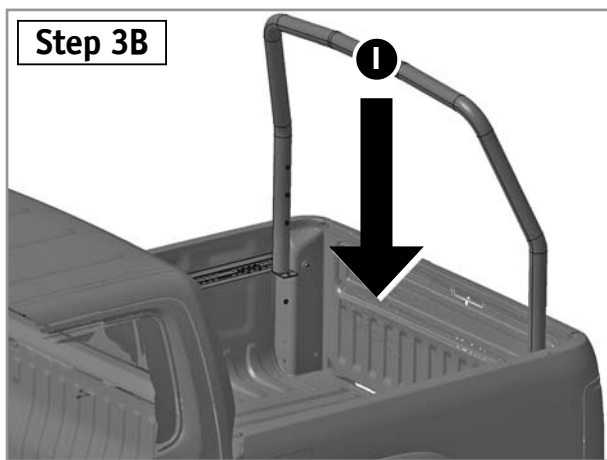
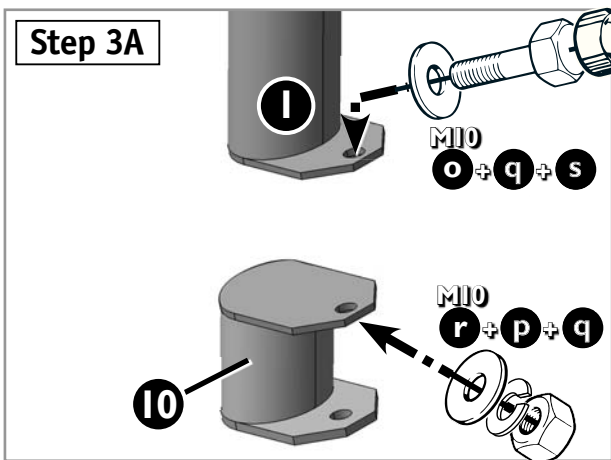
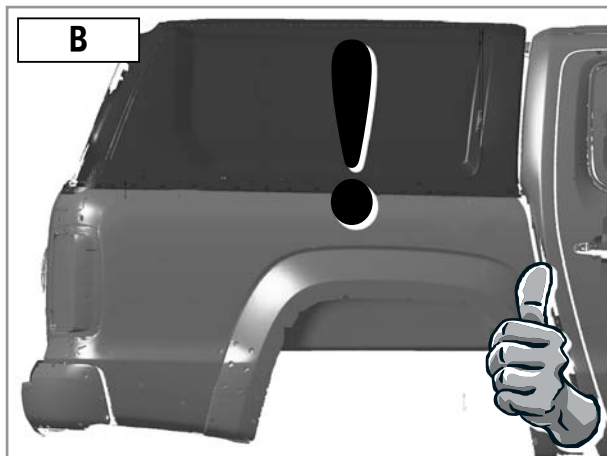
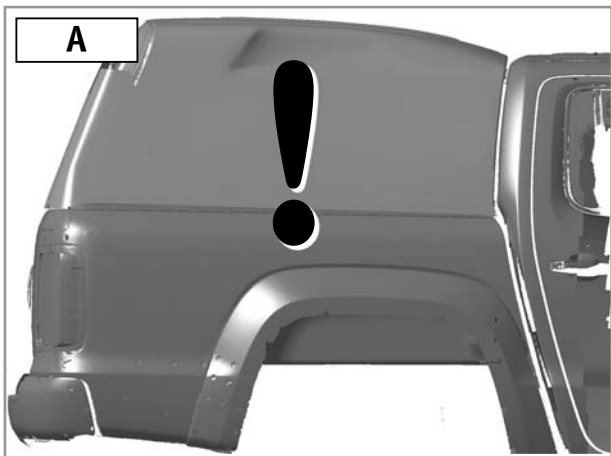
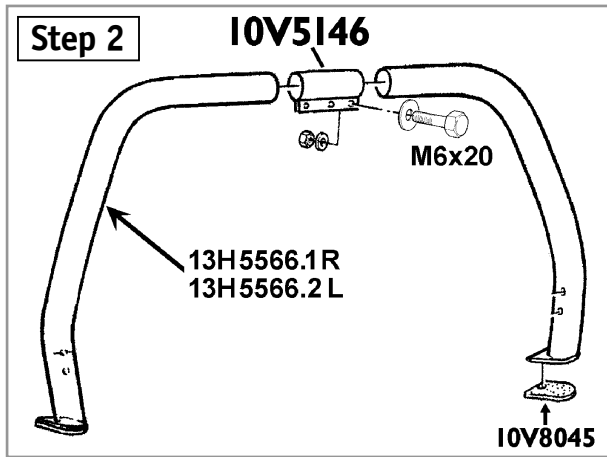
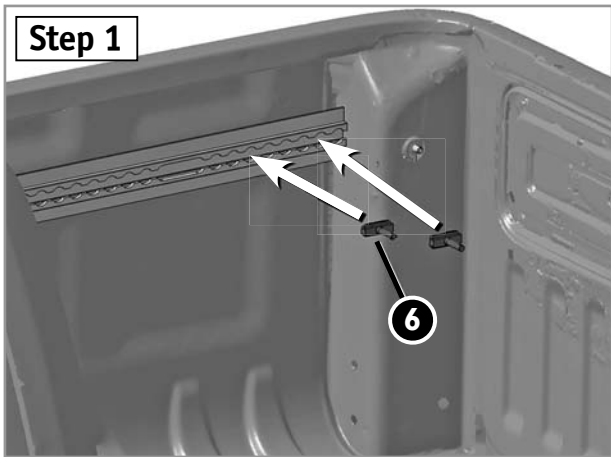

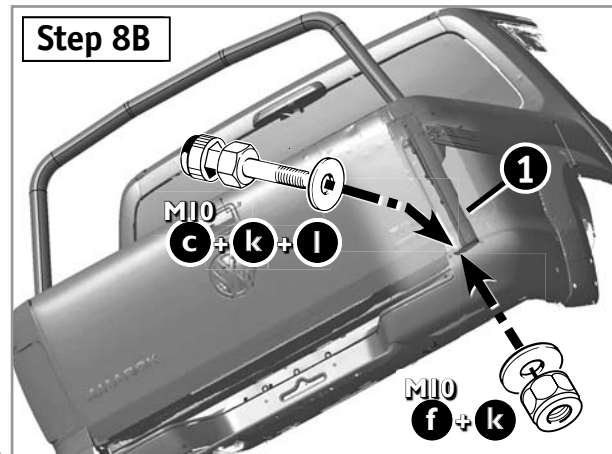
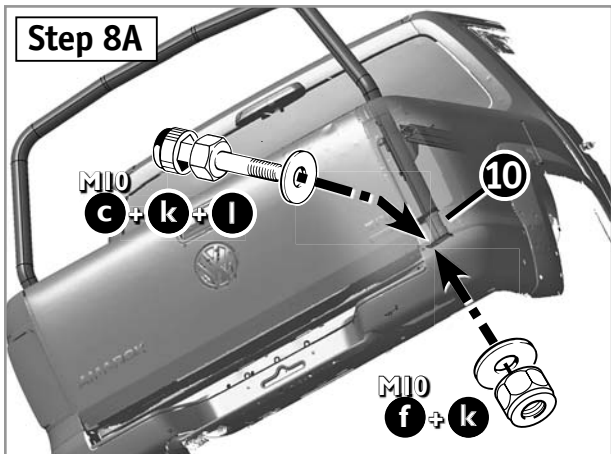
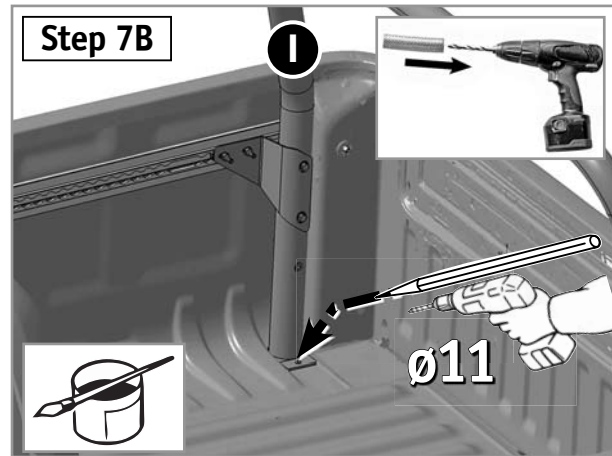
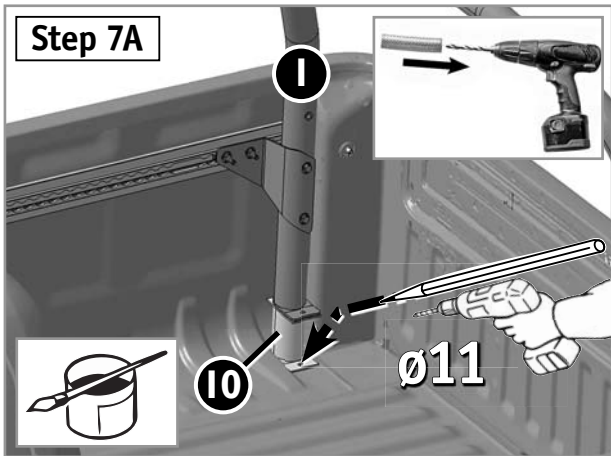
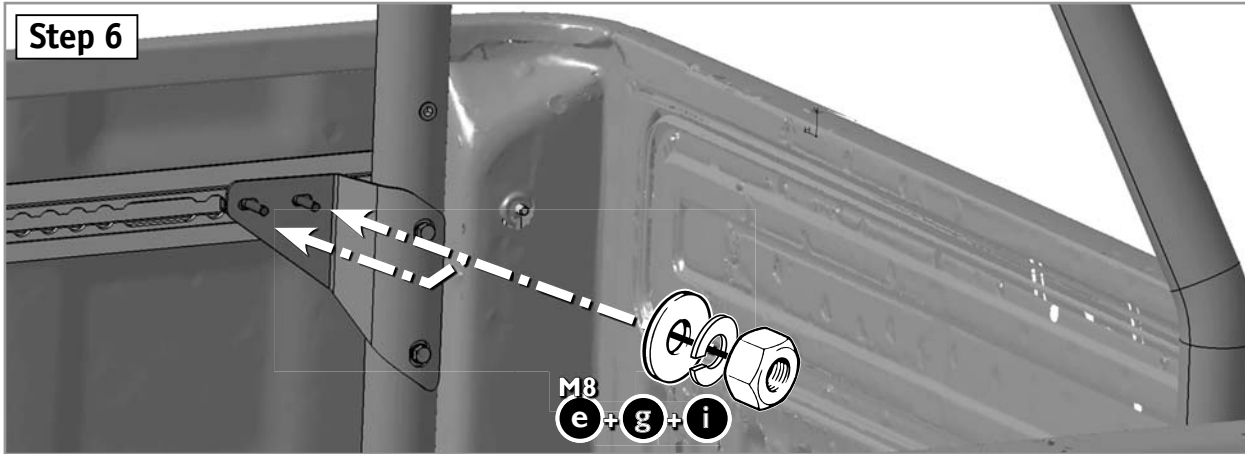
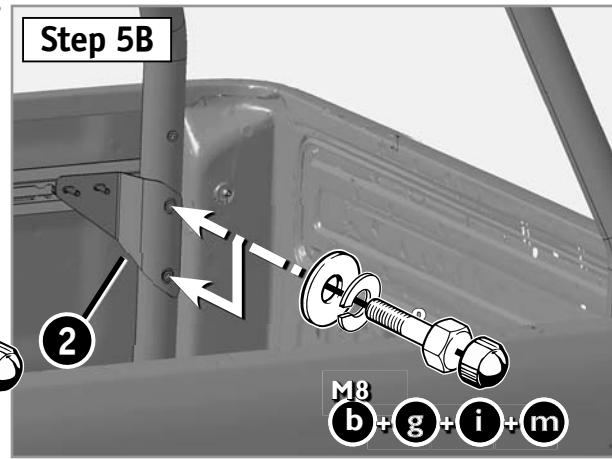
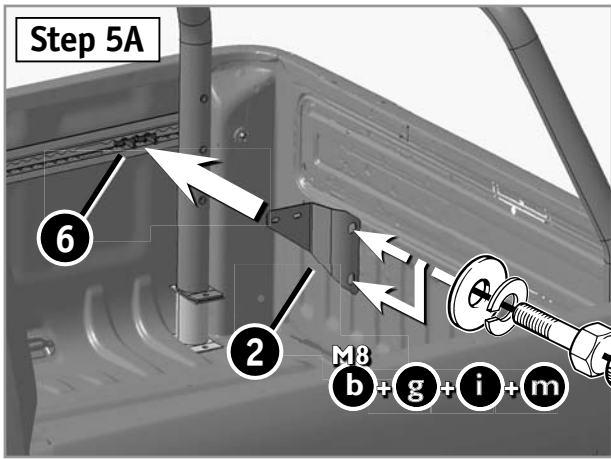

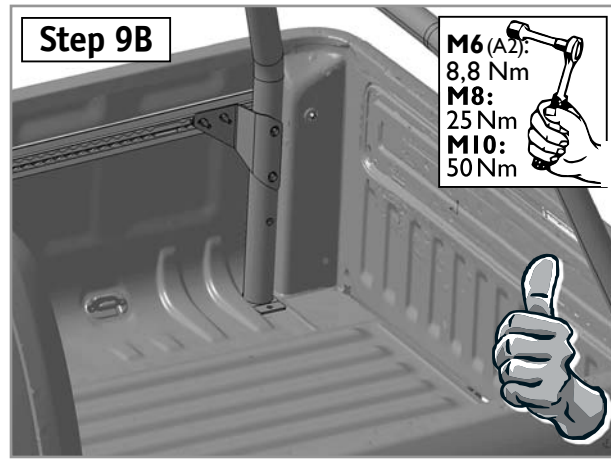
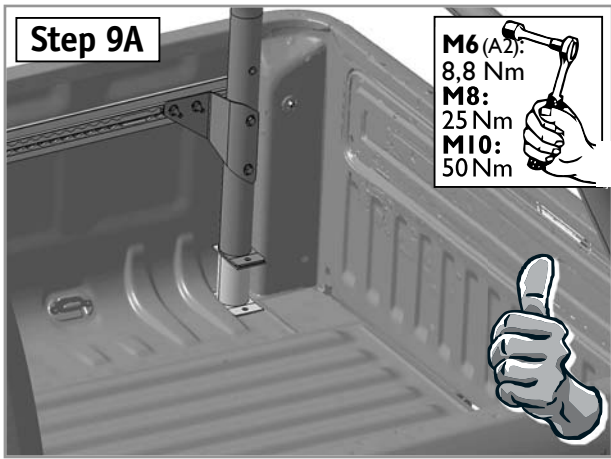

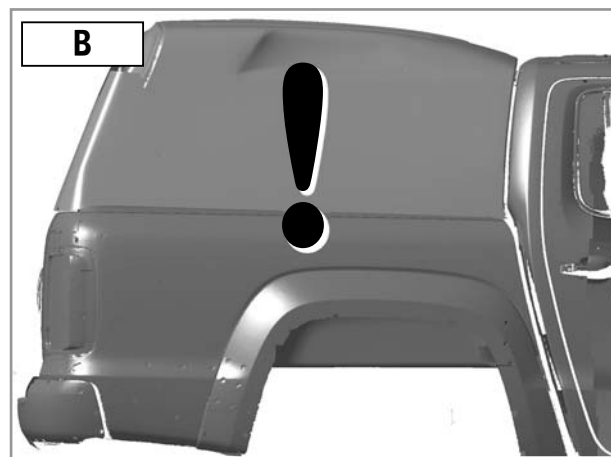
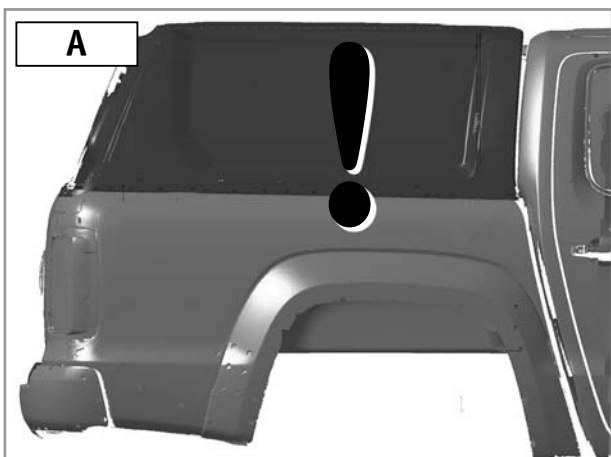
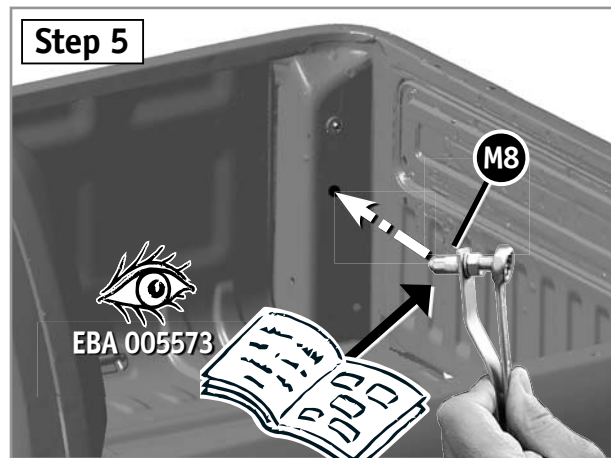
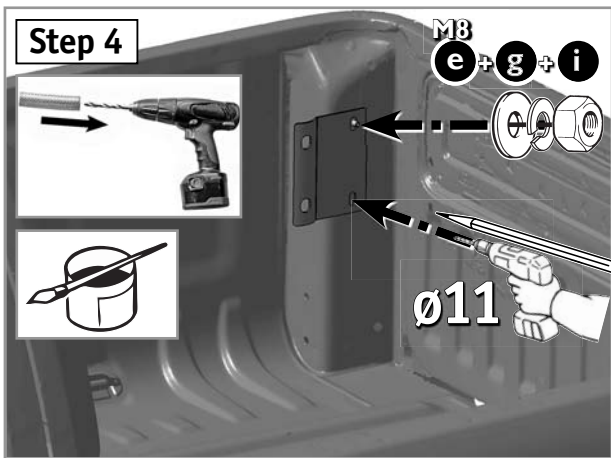
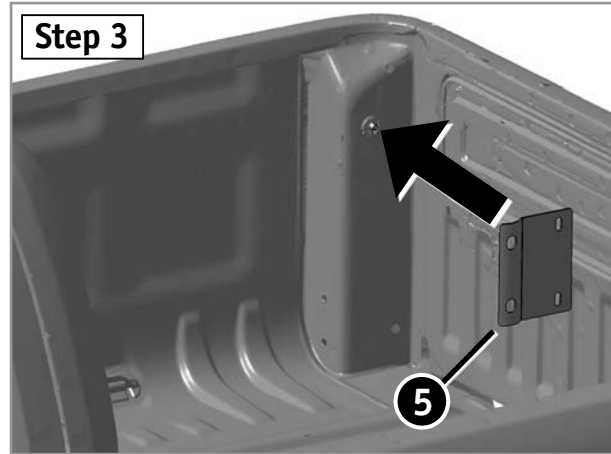
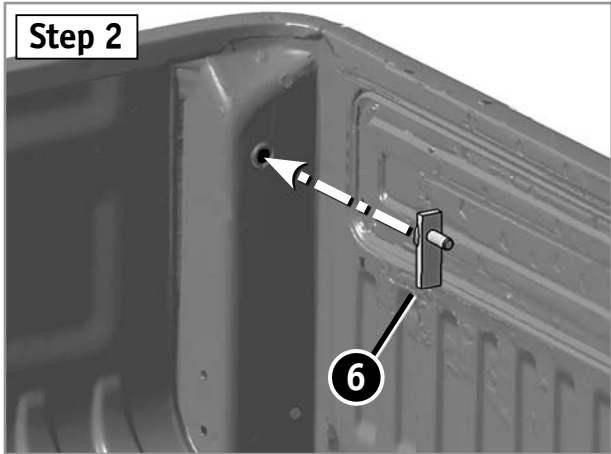
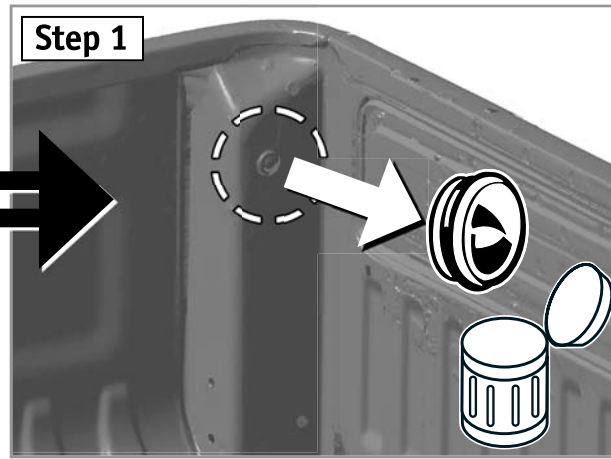
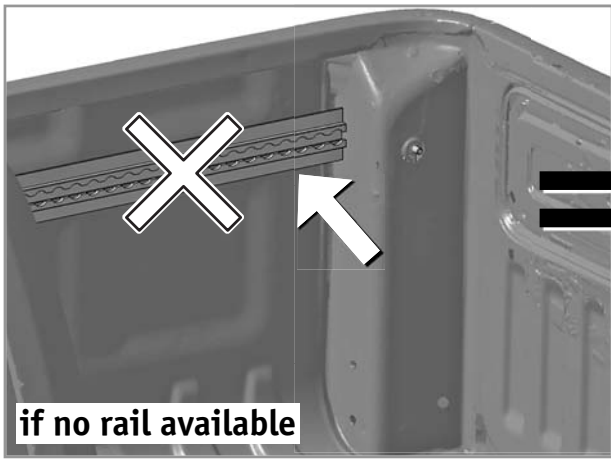

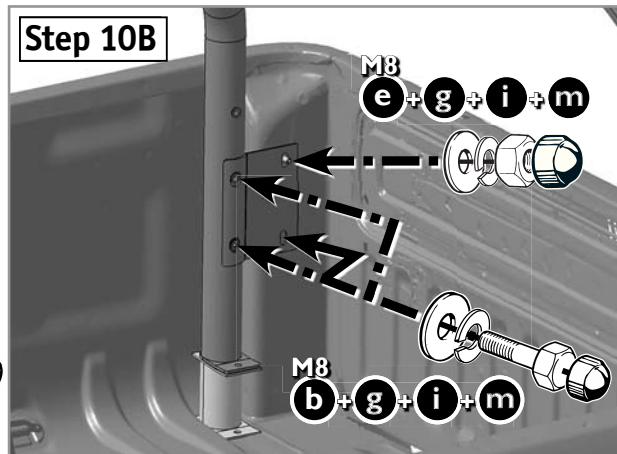
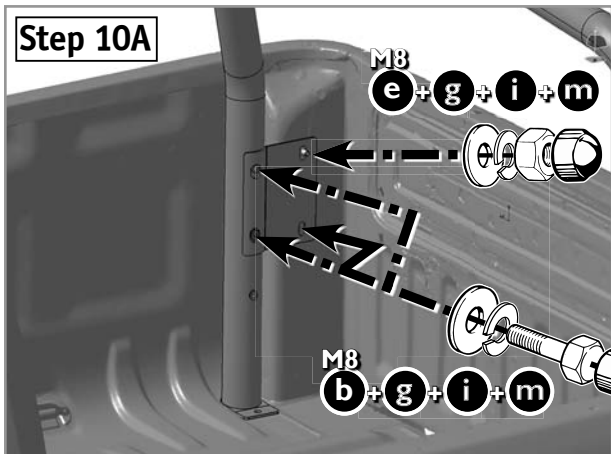
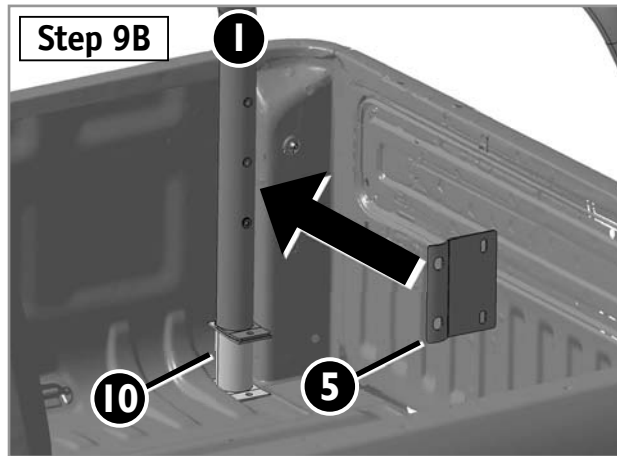
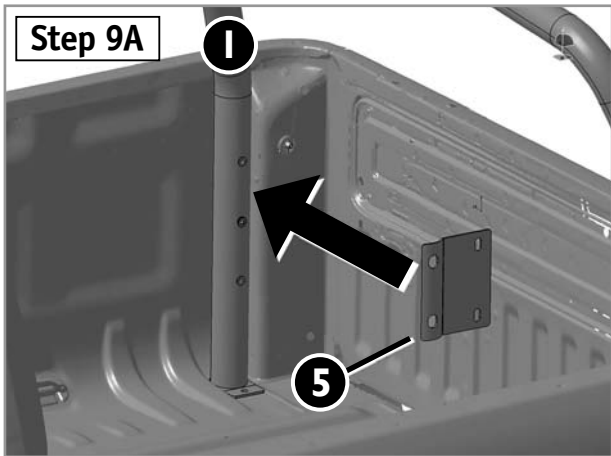
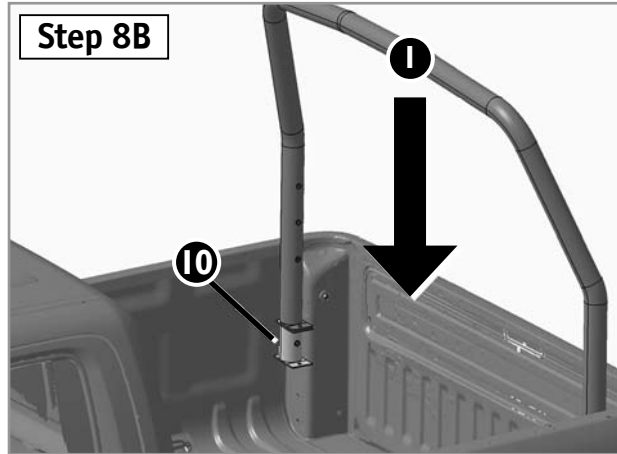
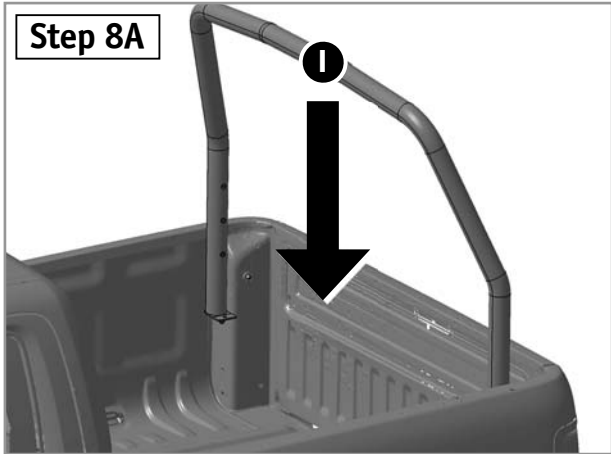
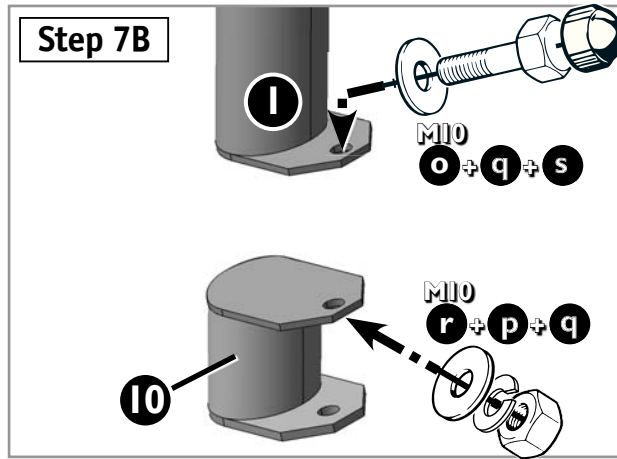
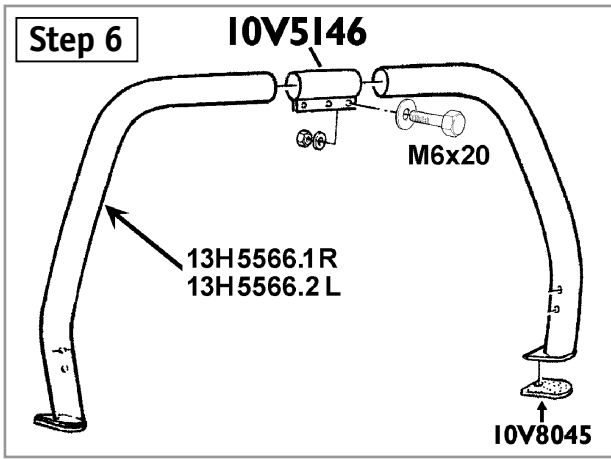

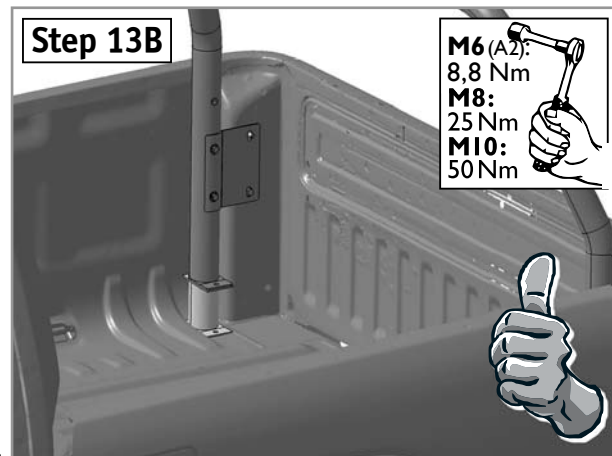
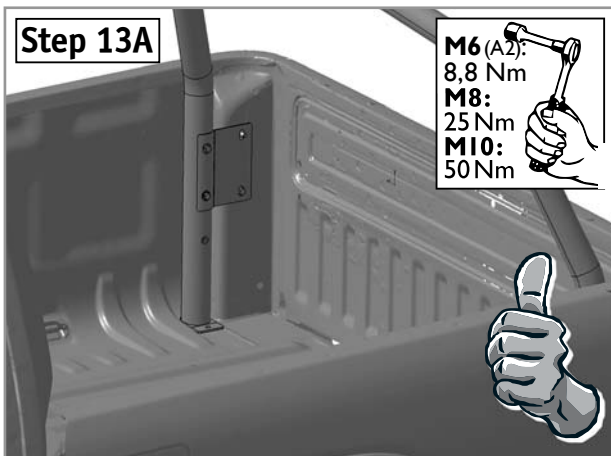
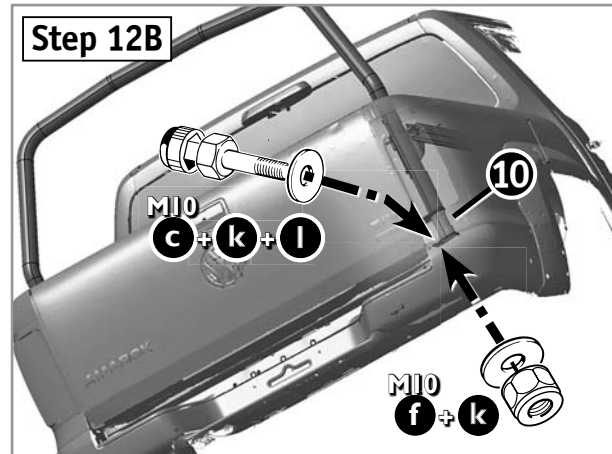
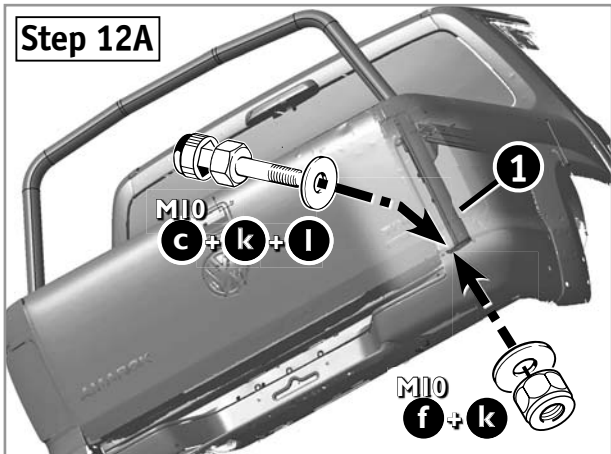
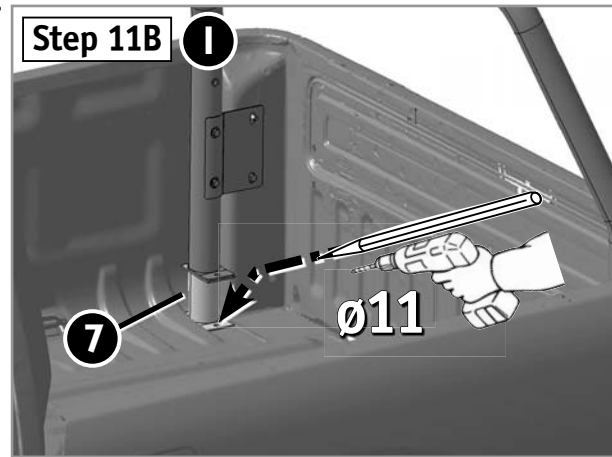
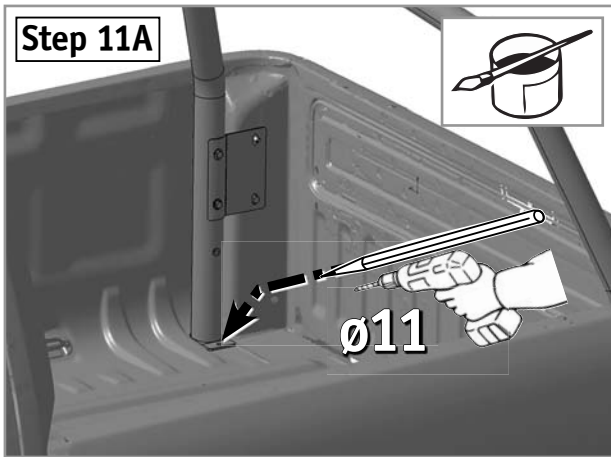

WWW.HOEHN.DE — ASSEMBLY WITH ADAPTER SET 13H5470

ROAD RANGER®

PICKUP-ACCESSORIES



MONTAGEANLEITUNG

ASSEMBLING INSTRUCTIONS

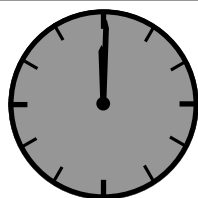
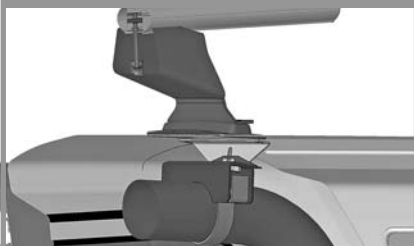

60 Minuten

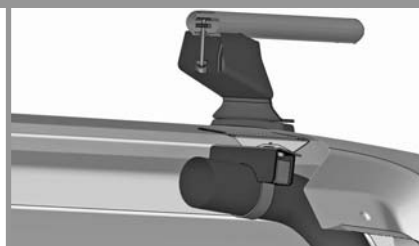

SHINGLE / CLAMP-SET / BRACKET-SET
DACHPLATTE / SCHELLEN-SATZ / WINKEL-SATZ

Article- Number:
10V4056; 10V5057; 10V5058
(1664056)

Artikel-Nr:
10V 4056 / 10V 5057/ 10V 5058 **Revision 2:** 10.11.2011

WWW.ROADRANGER.DE

ROAD RANGER®

PICKUP-ACCESSORIES

Dachplatte 10V 4056 oder 166 4056 / shingle 10V 4056 / Placa de techo 10V 4056

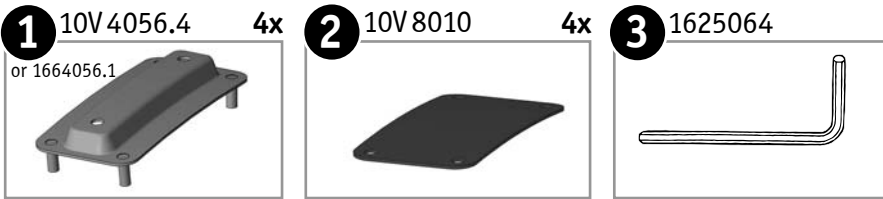

Standard Parts / Normteile

a		M6 x16; ISO 7380 A2	8x	c		ø6; DIN 127 A2	8x
b		M6; DIN 985 A2	16x	d		ø6,4; DIN 9021 A2	16x

Schellen-Satz 10V 5057 / Bracket-set 10V 5057 / juego de abrazadera 10V 5057 2x

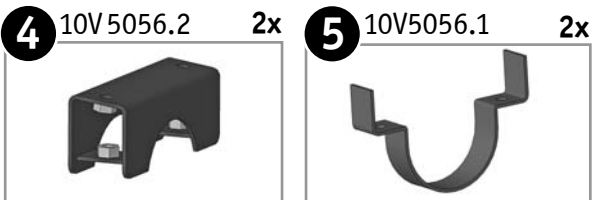

Standard Parts / Normteile

e		M6 x16; DIN 933	8x	g		ø6,4; DIN 125	8x
f		ø6; DIN 127	8x				



benötigte Werkzeuge

ASSEMBLING INSTRUCTIONS: REQUIRED TOOLS

SW: 10 mm



A2:
M6: 8,8 Nm
Zn:
M6: 10 Nm

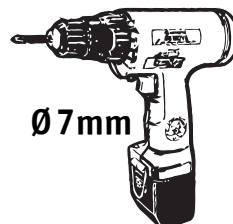

Ø 7 mm



SHINGLE / CLAMP-SET / BRACKET-SET
DACHPLATTE / SCHELLEN-SATZ / WINKEL-SATZ

Article- Number:

10V4056; 10V5057; 10V5058
(1664056)

Artikel-Nr:

10V 4056 / 10V 5057 / 10V 5058 Revision 2: 10.11.2011

WWW.ROADRANGER.DE



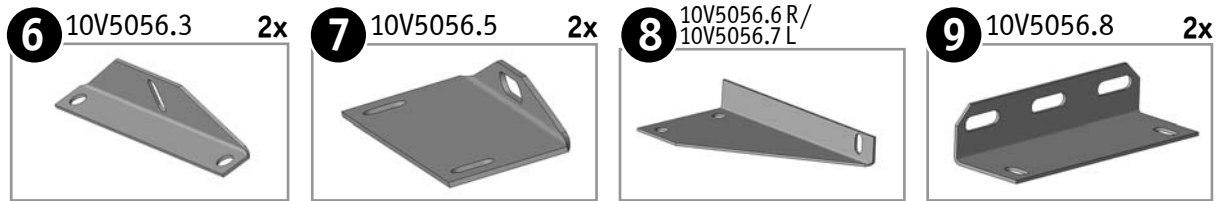

ROAD RANGER®

PICKUP-ACCESSORIES

Winkel-Satz 10V 5058 / angle bracket-set 10V5058 / juego de escuadra 10V5058 **2x**

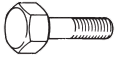

Standard Parts / Normteile

h		M6 x16; DIN 933	2x	k		ø6; DIN 127	2x
i		M6; DIN 934	2x	m		ø6,4; DIN 125	4x

NOT INCLUDED / Nicht enthalten

10 Gepäckträger Schiene



11 GTr Halter

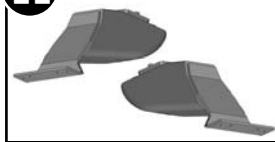

benötigte Werkzeuge

ASSEMBLING INSTRUCTIONS: REQUIRED TOOLS

SW: 10 mm



A2:
M6: 8,8 Nm
Zn:
M6: 10 Nm

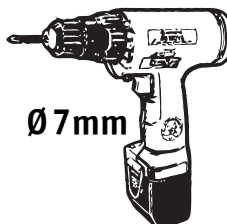

Ø 7 mm



SHINGLE / CLAMP-SET / BRACKET-SET
DACHPLATTE / SCHELLEN-SATZ / WINKEL-SATZ

Article- Number:

10V4056; 10V5057; 10V5058
(1664056)

Artikel-Nr:

10V 4056 / 10V 5057 / 10V 5058 **Revision 2: 10.11.2011**

WWW.ROADRANGER.DE

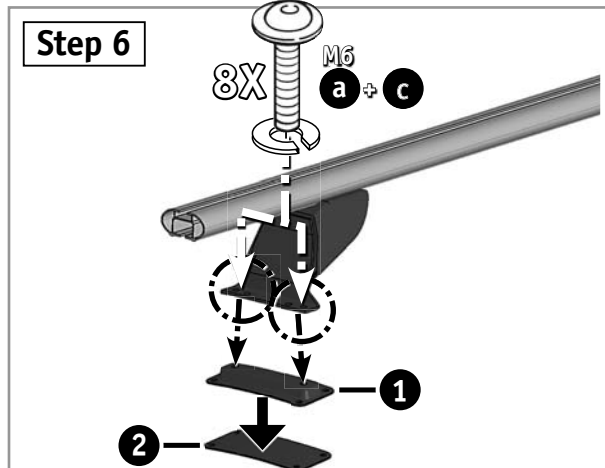
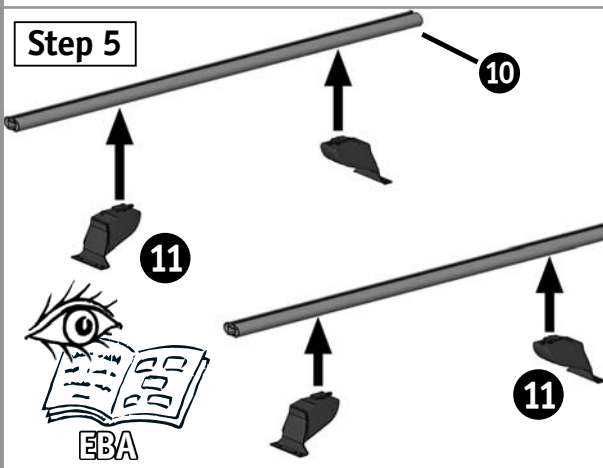
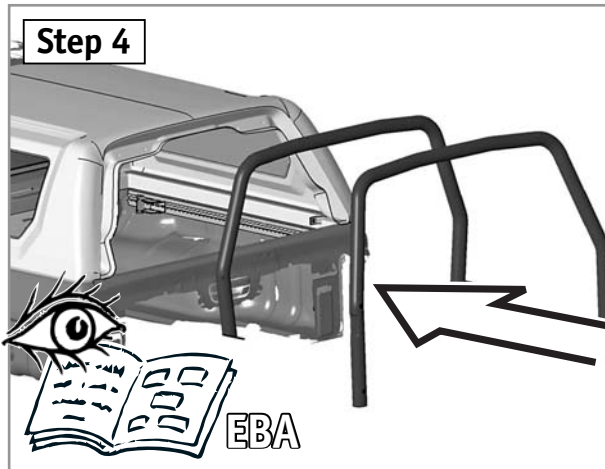
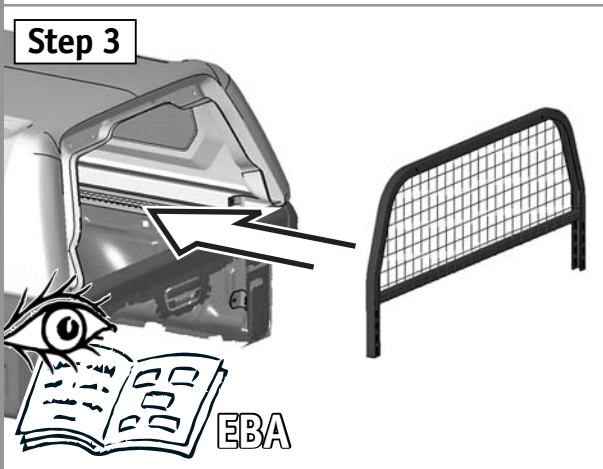
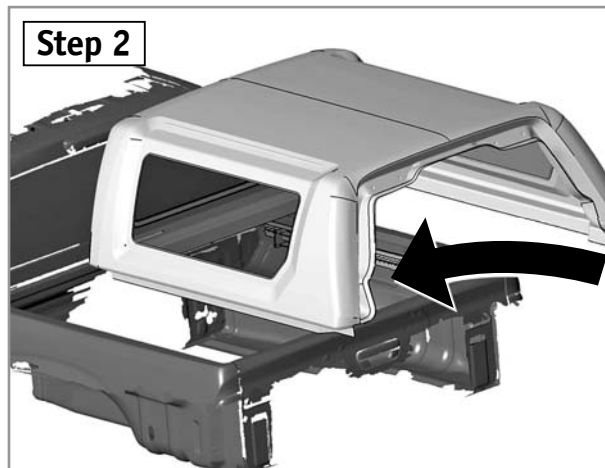
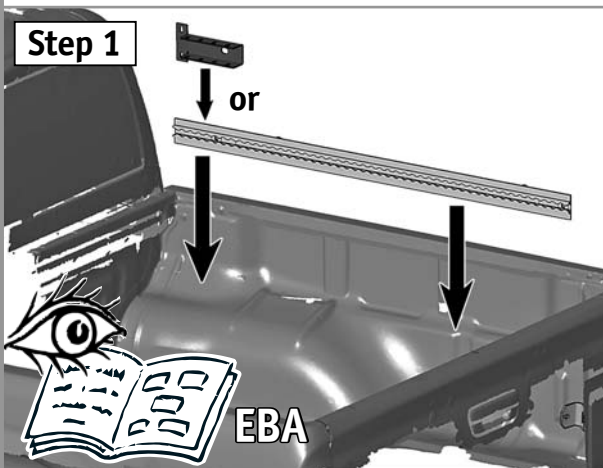
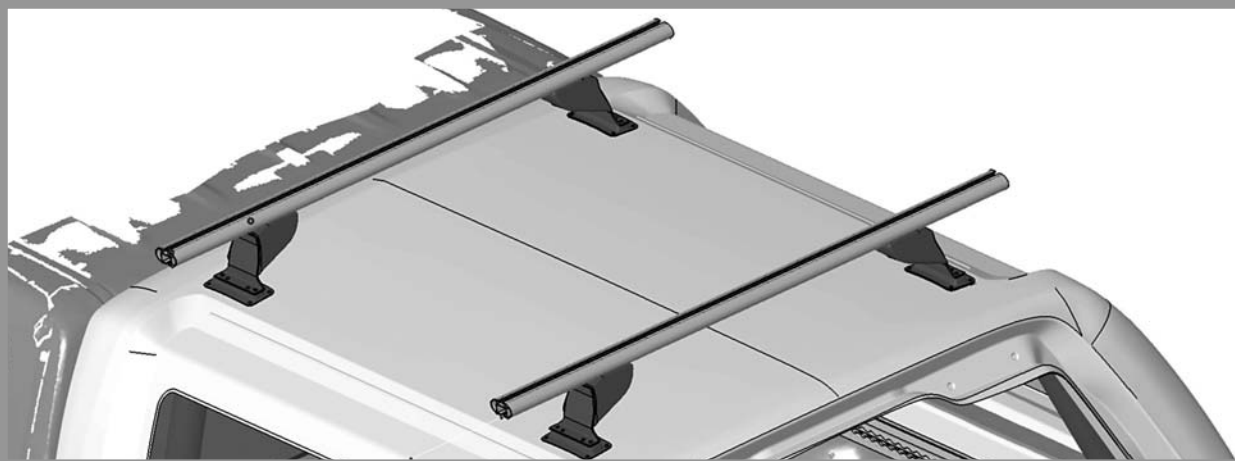

Artikel-Nr:
10V 4056 / 10V 5057 / 10V 5058 Revision 2: 10.11.2011

Step 7



Step 8

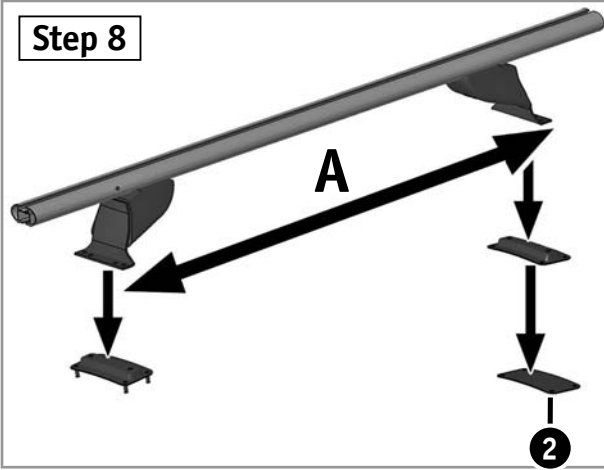

Step 9

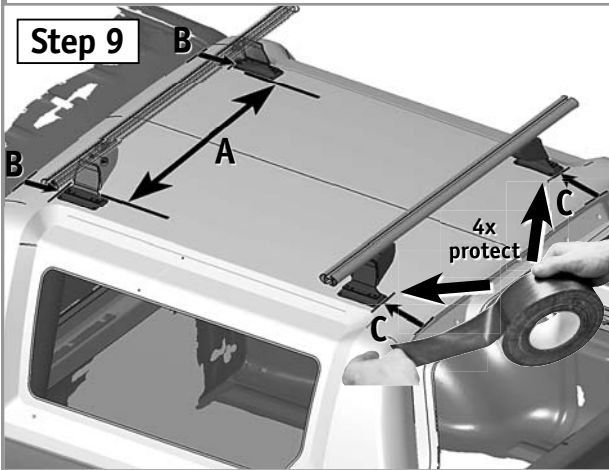

Step 10

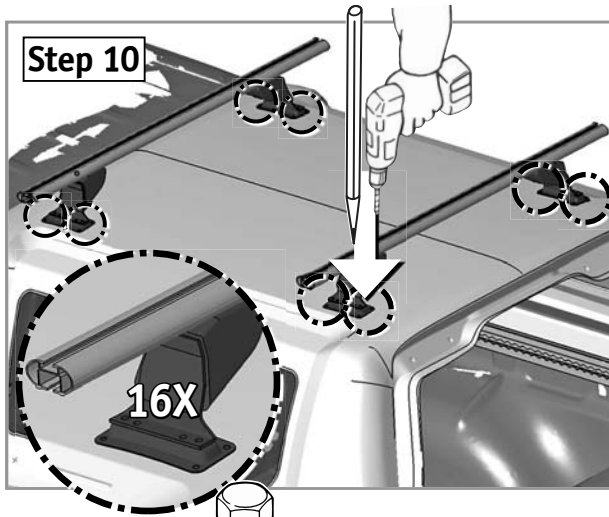

Step 11

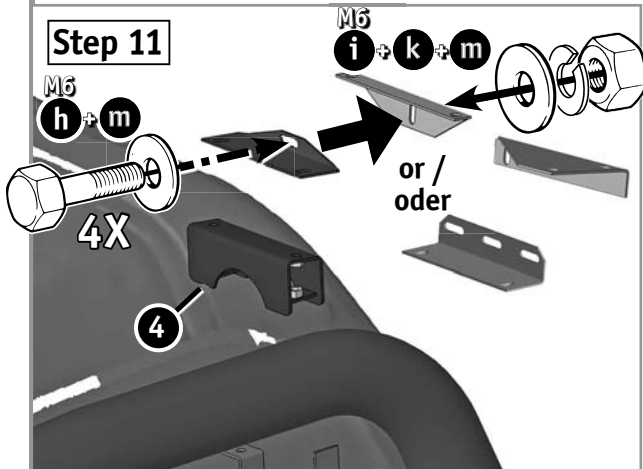

Step 12

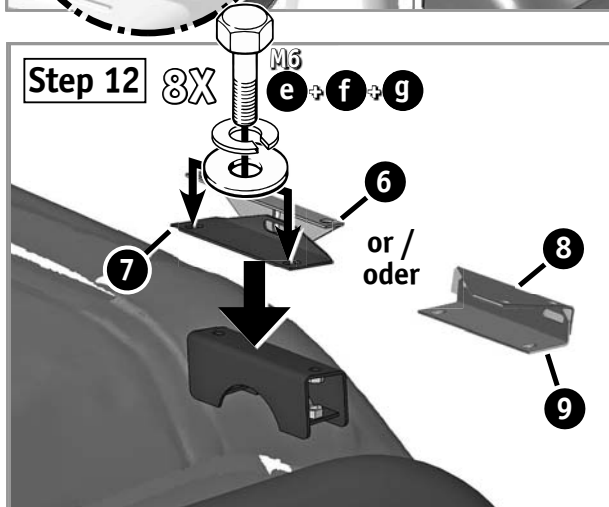

Step 13

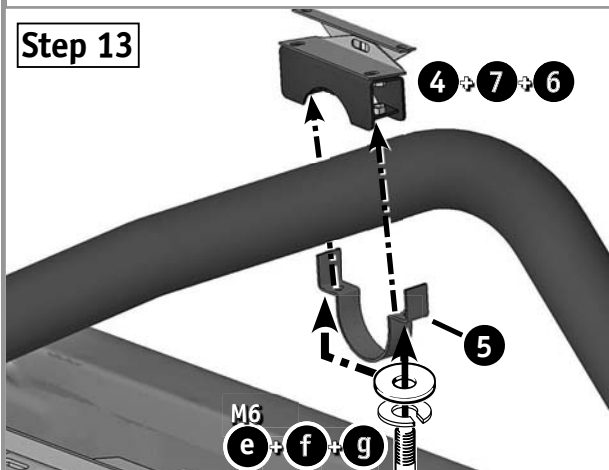

Step 14

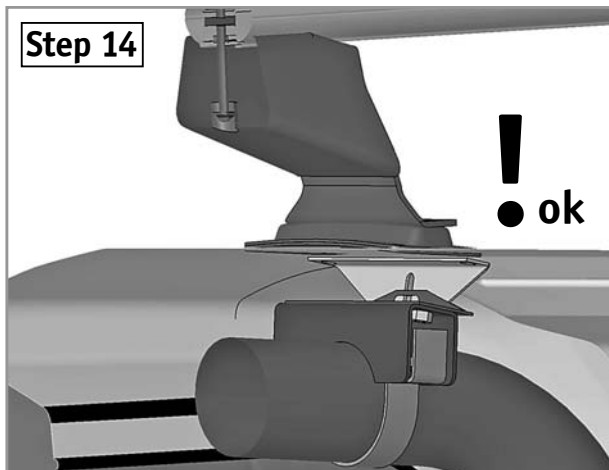

Artikel-Nr:
10V 4056 / 10V 5057 / 10V 5058 Revision 2: 10.11.2011

Step 15

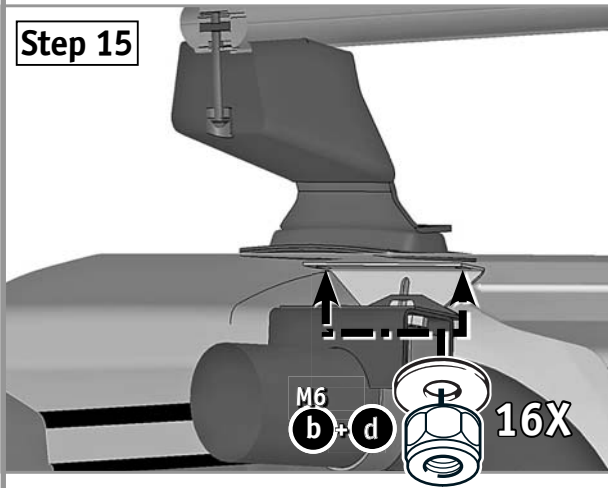

Step 16

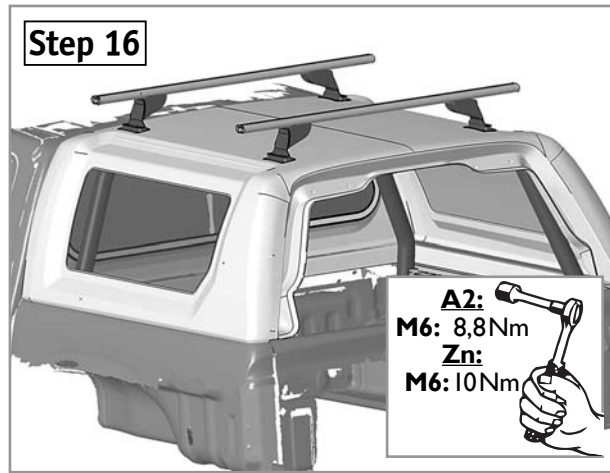

Step 17

