

Anbauanleitung: Scheinwerferhalterset Mitsubishi L200 abBj.2015

AL: 2098-01

Best.Nr.: 35-T7400070

*Hier sehen sie das fertig montierte Scheinwerferset.
Bevor sie mit der Montage beginnen, lesen sie bitte diese Anleitung und
das Benutzerhandbuch der Scheinwerfer gut durch.*

*Before you start fitting, please read and understand this instruction manual and
the owners manual of the lights.*



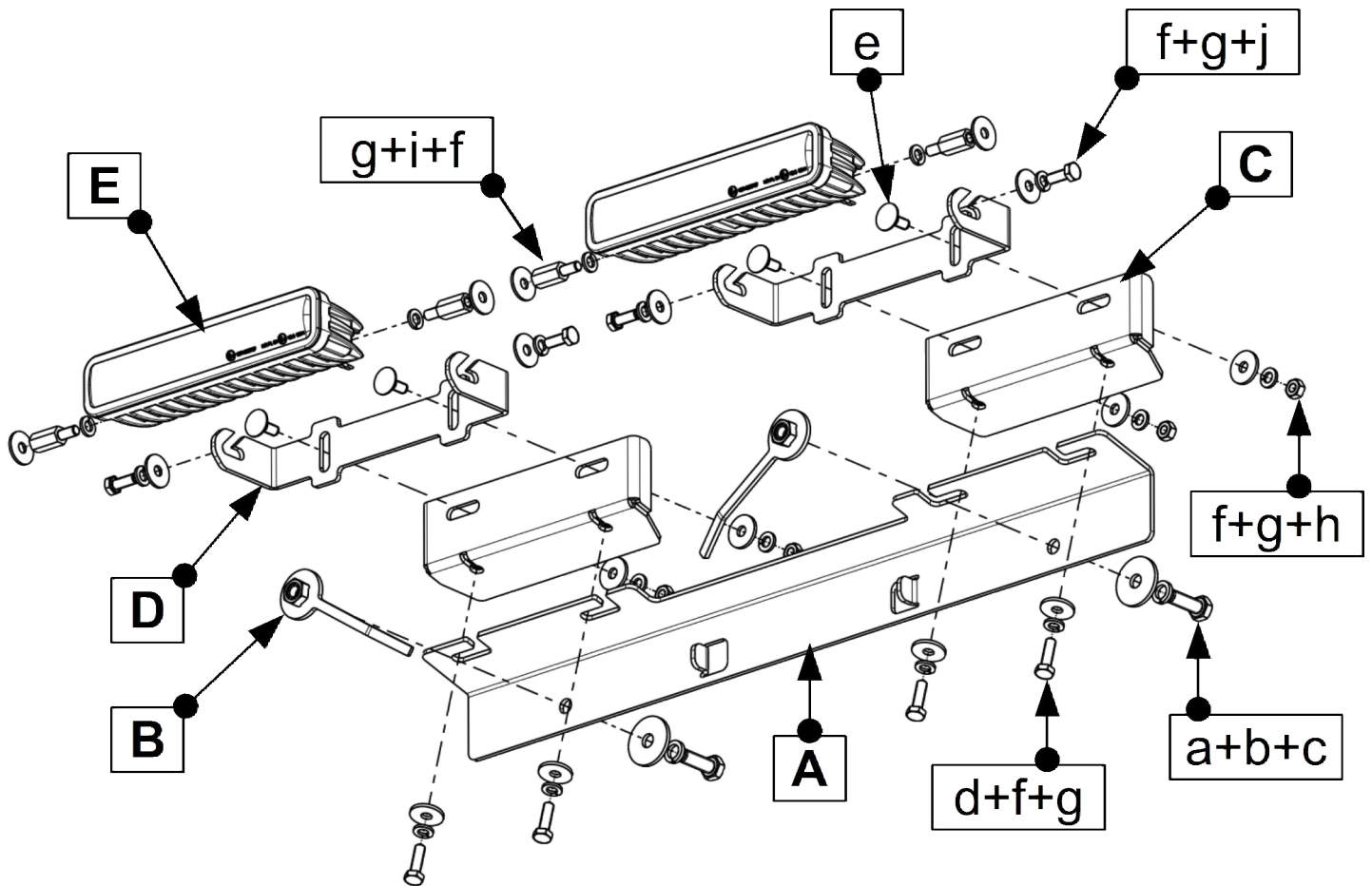

Stückliste

35-T740007

Schraubensatz

1x Grundträger (A)
 2x Einlageblech (B)
 2x Zwischenblech (C)
 2x Scheinwerferhalter (D)
 2x 36-3LEDDL105-SP,
 Osram LED Scheinwerfer SX180-SP (E)
 1x Anbauanleitung AL2098

2x Schraube M8x25 (a)
 2x U-Scheibe M8 x30 x2,5 (b)
 2x Federring M8 (c)
 4x Schraube M6x20 (d)
 4x Flachrundschraube M6x16 (e)
 16x Scheibe 6,5x20x2 (f)
 16x Federring M6 (g)
 4x Mutter M6 (h)
 4x Abstandsbolzen M6 x 20 (i)
 (Würth Art.-Nr. 44985620)
 4x Schraube M6 x 16 (j)

2x

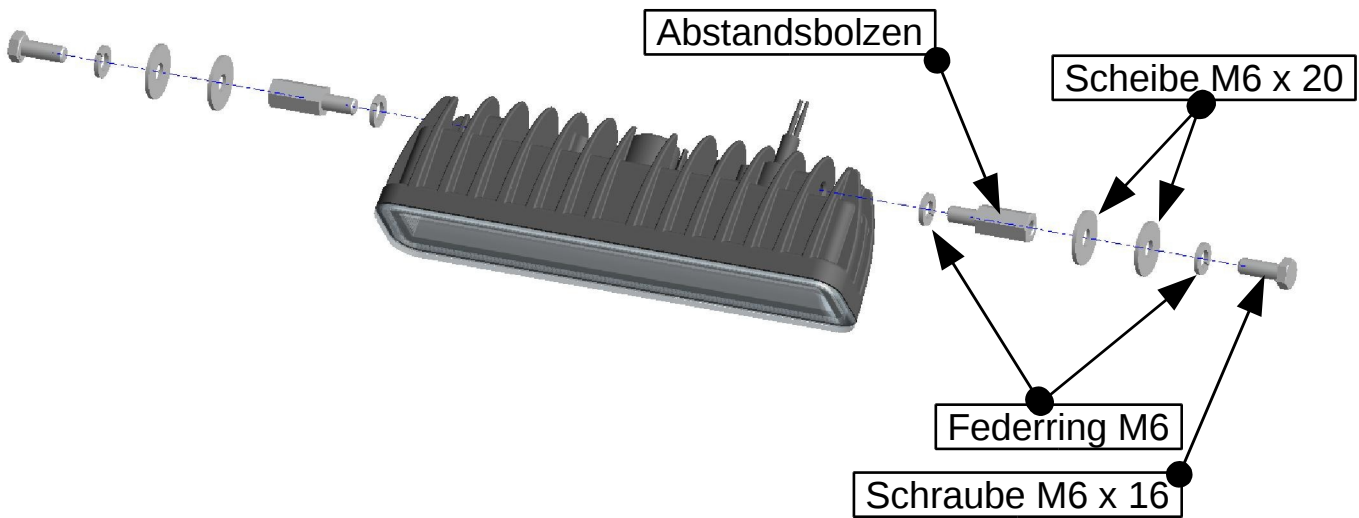

1

Abstandsbolzen festziehen, Schrauben nur lose lassen!
Tighten the spacer bolt, leaving the bolts loose!



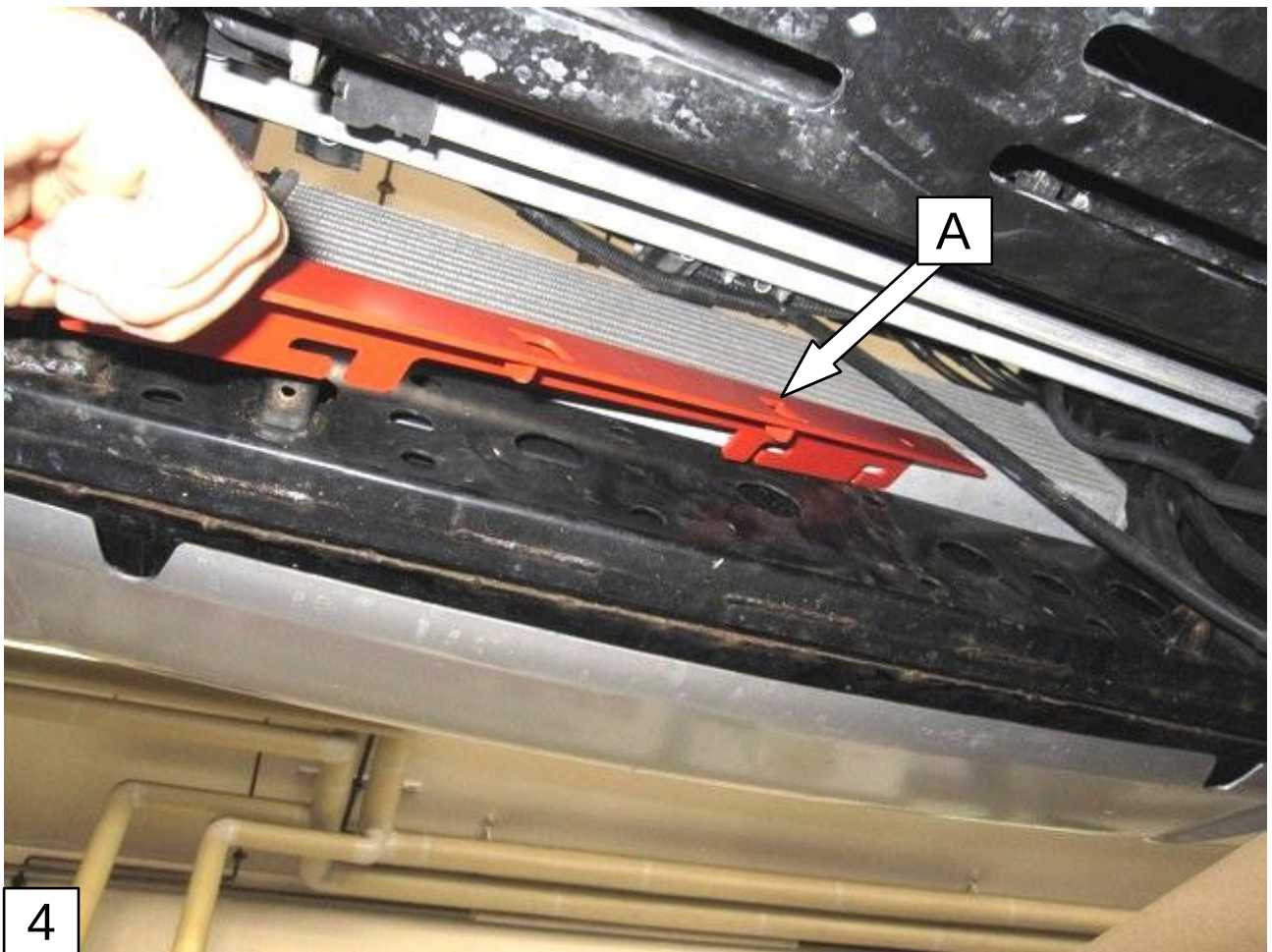
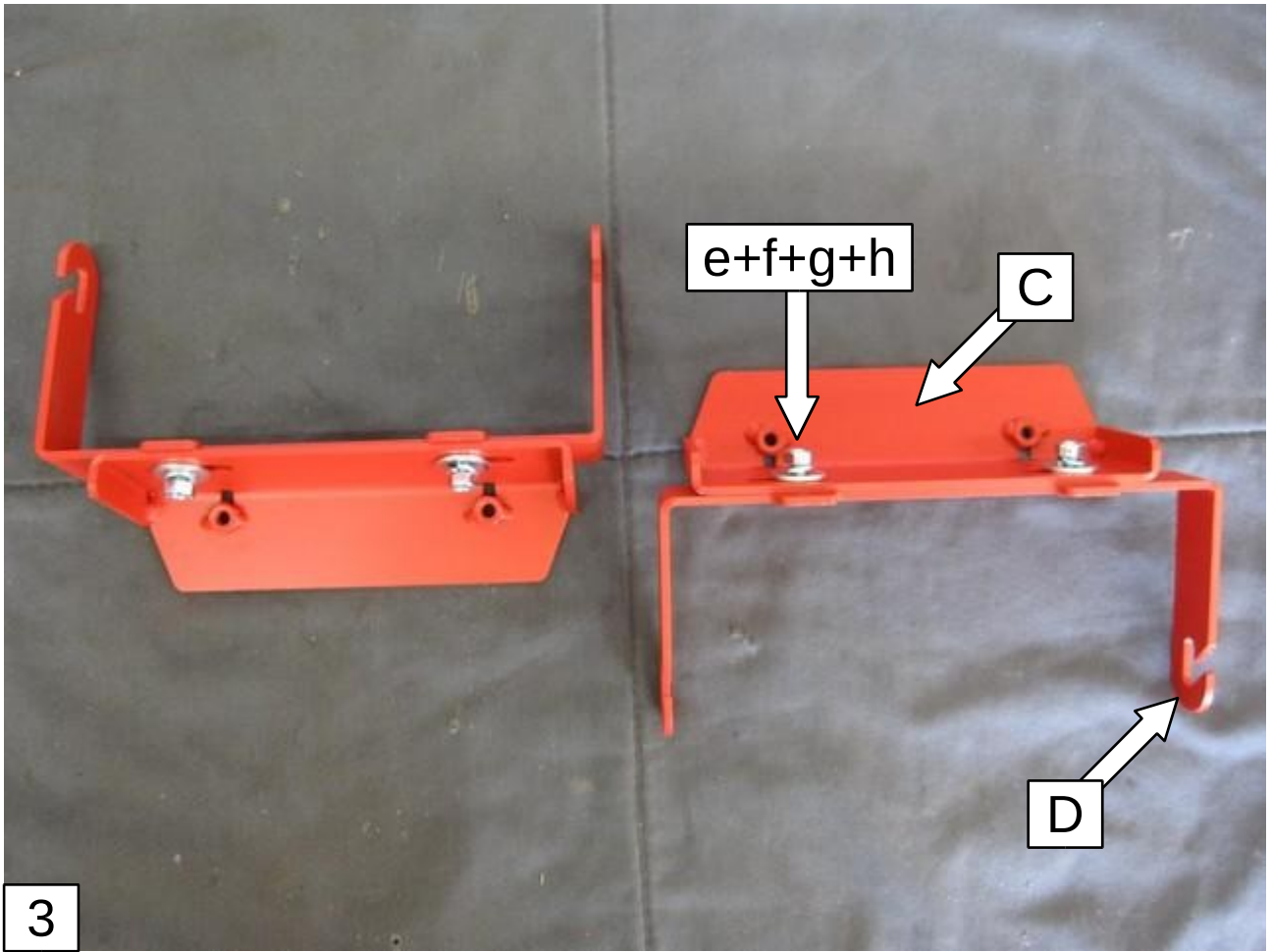

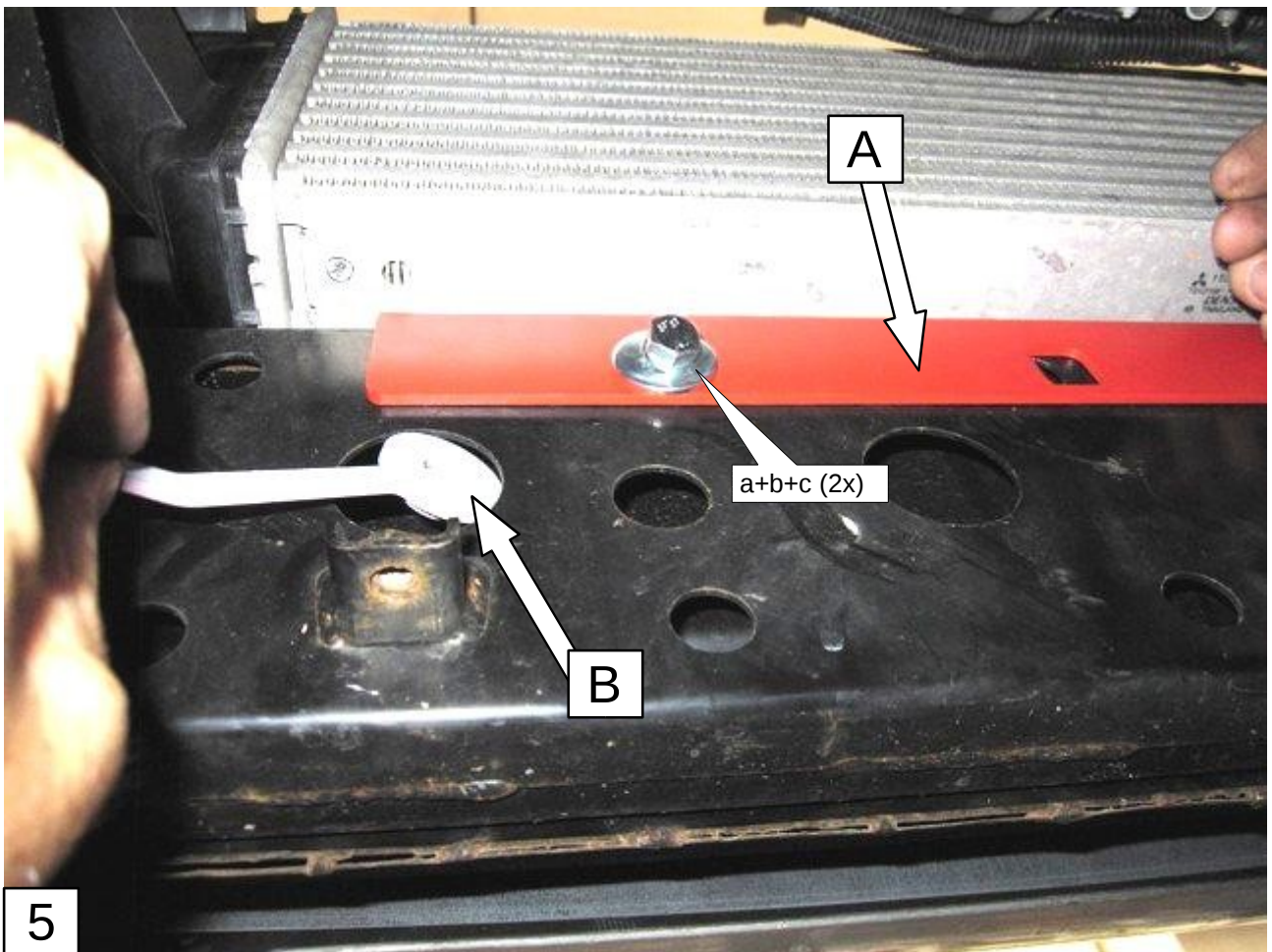

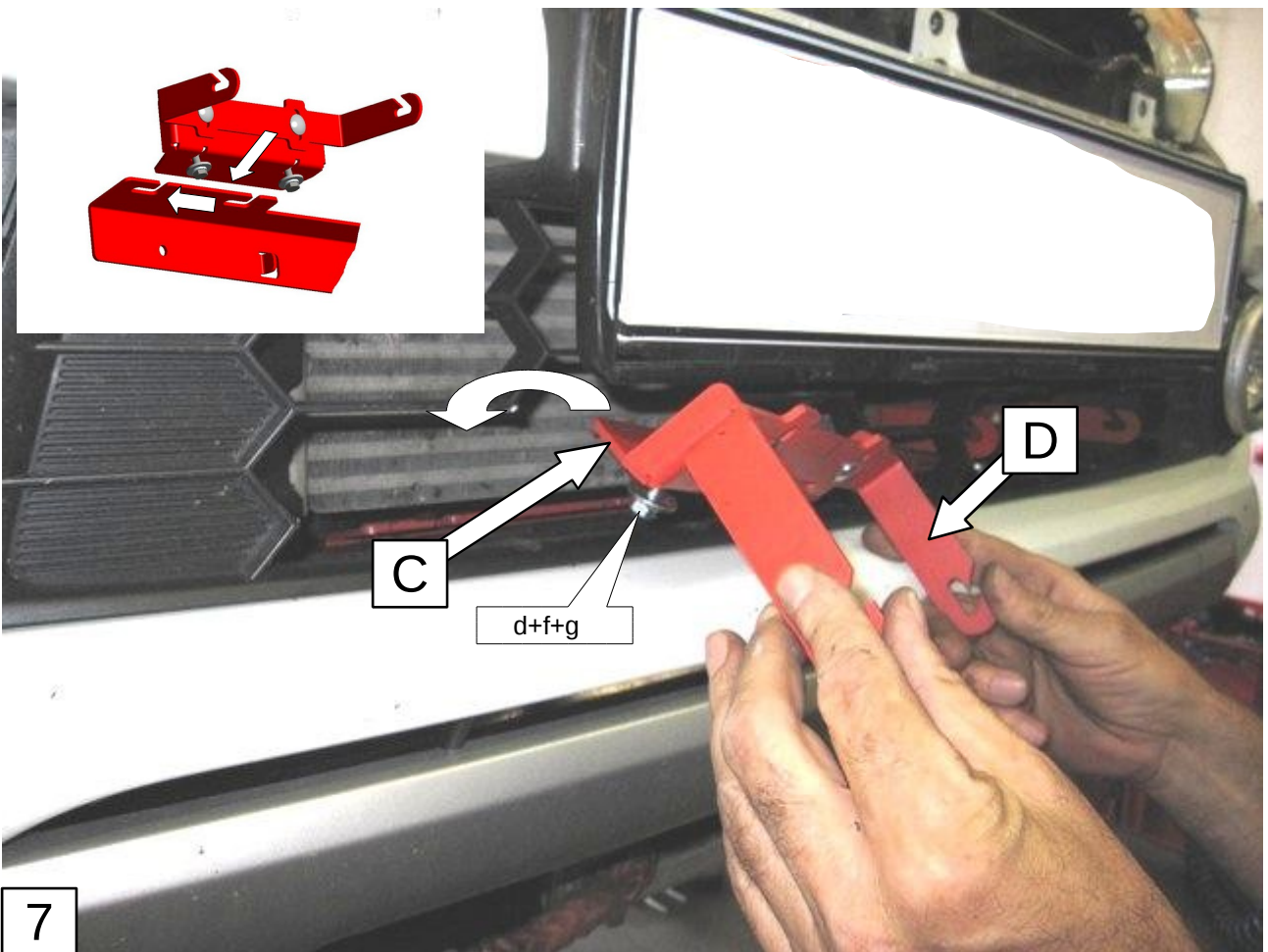

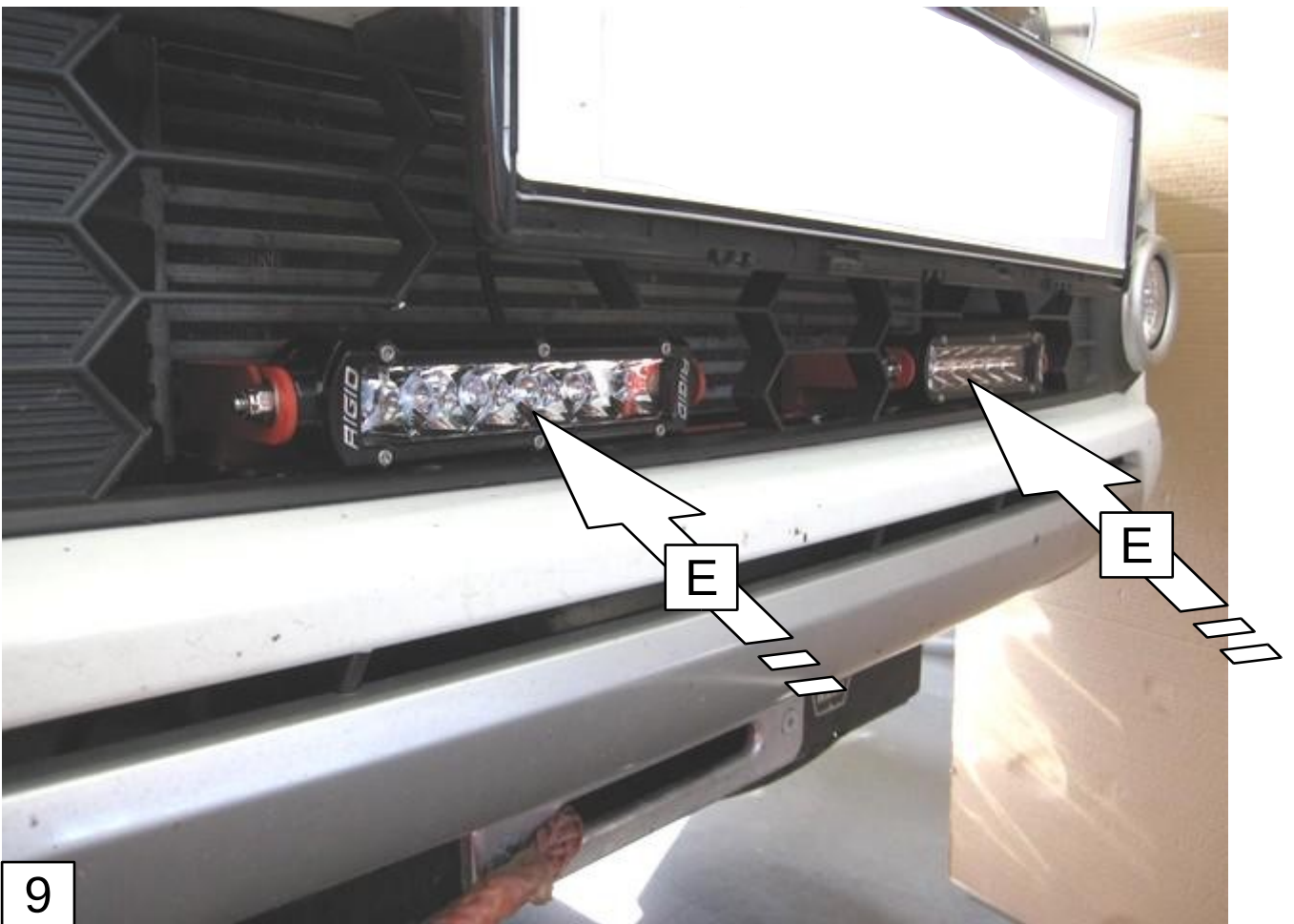
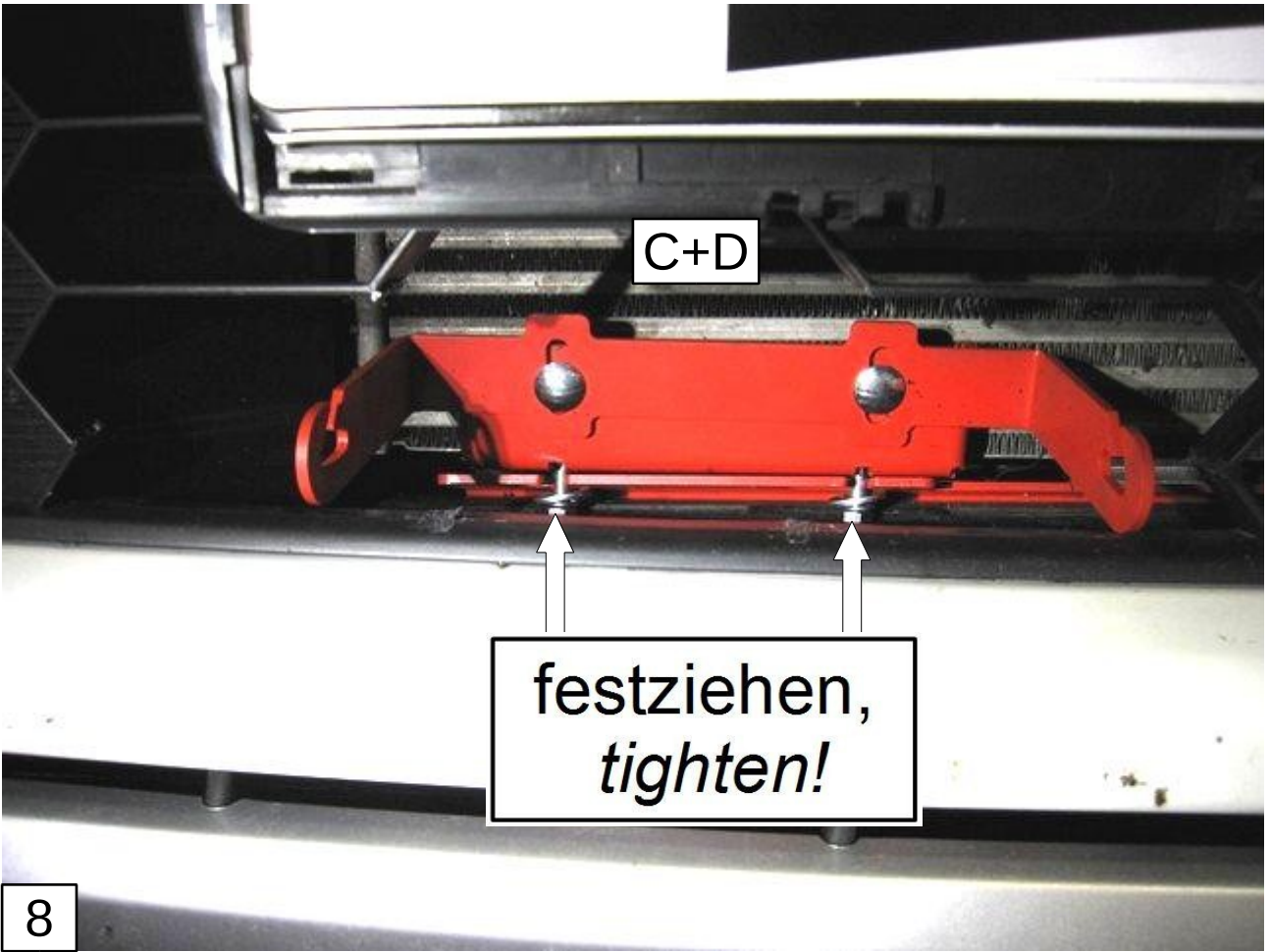

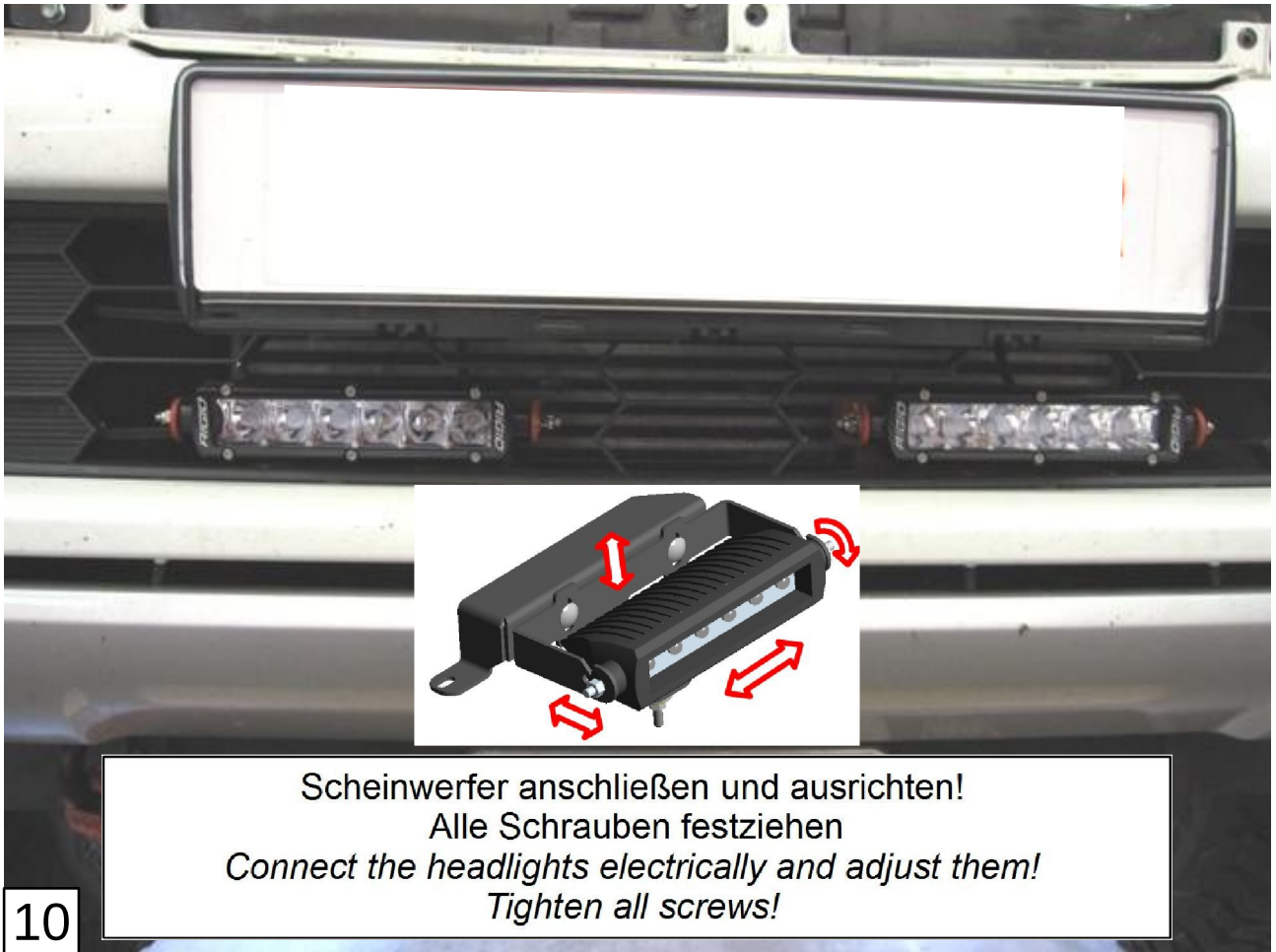

10