



INSTALLATION INSTRUCTIONS (K439)

TANGO Rail Protection

FOR RAN MAZ BT50 DC 11+

<p>A</p> <p>(RIGHT) X1</p>	<p>B</p> <p>(LEFT) X1</p>	<p>C</p> <p>(TAILGATE) X1</p>	<p>D</p> <p>(FRONT) X1</p>
<p>E</p> <p>Corner Bracket X2</p>	<p>F</p> <p>M6 Grub Screw X4</p>	<p>G</p> <p>C Clamp X6</p>	<p>H</p> <p>M8x30mm Bolt X6</p>
<p>I</p> <p>M8 Spring Washer X6</p>	<p>J</p> <p>M8 Washer X6</p>	<p>K</p> <p>Plastite screw X4</p>	<p>L</p> <p>Nylon Self-retain Washer X4</p>
<p>M</p> <p>M6x20mm Screw X2</p>	<p>N</p> <p>12mm Thick Foam Seal X1</p>	<p>O</p> <p>Long Rivet X4</p>	<p>◇ = EXISTING PART (not supplied)</p> <p>○ = NEW PART (supplied)</p>
<p>1</p>		<p>2</p> <p>LOOSELY!</p>	

Fitting Kit Number	Manufacturer	Model Type	Year	Stockist	Cab Size	Product	Revision	Date	Page
K439	Ford/Mazda	Ranger/BT50	2011	-	DC	TANGO	3	24/7/2016	1 of 4

WITH PRO-FORM UR LINER

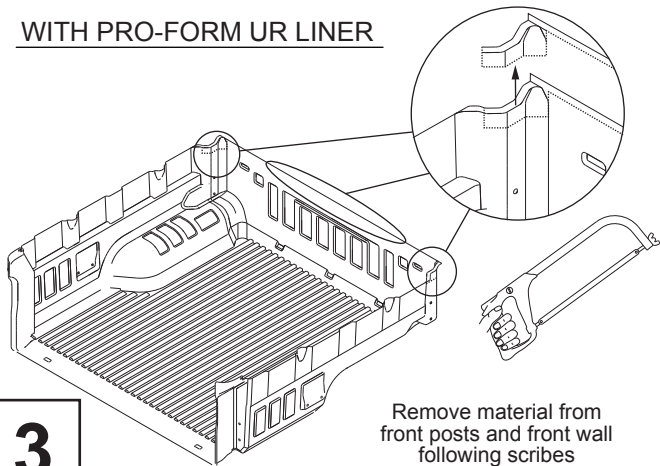

3

Remove material from front posts and front wall following scribes

WITH PRO-FORM SPORTGUARD

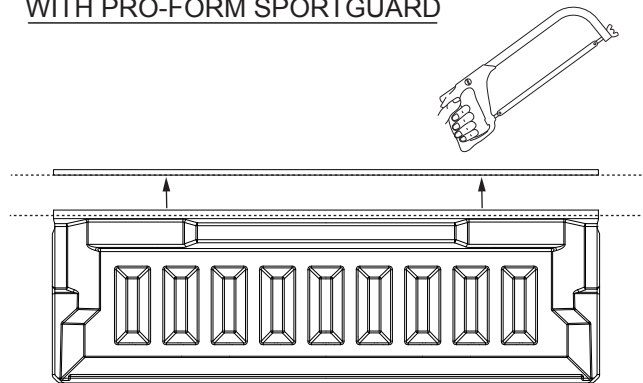

Remove 15mm material from top of front wall

4

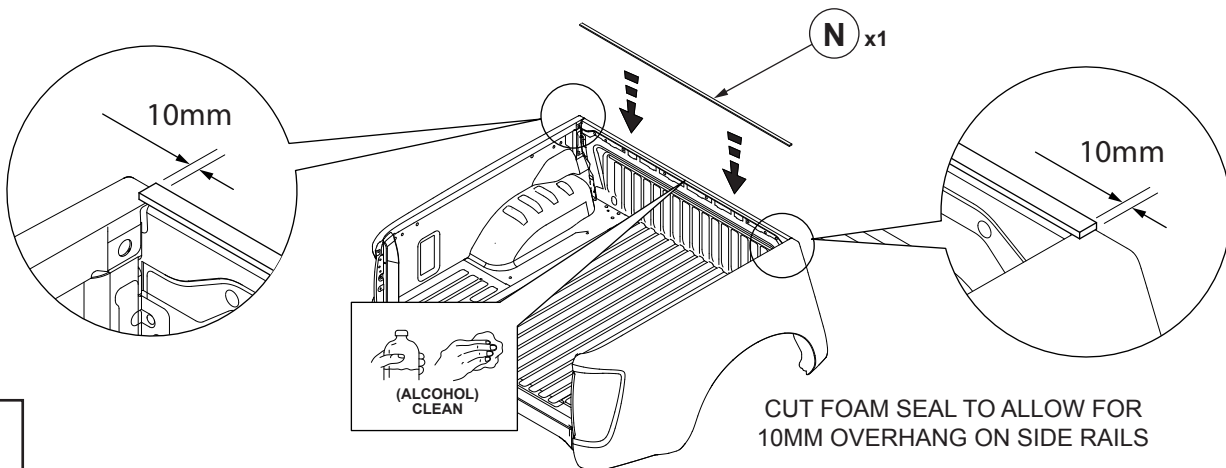

CUT FOAM SEAL TO ALLOW FOR 10MM OVERHANG ON SIDE RAILS

5

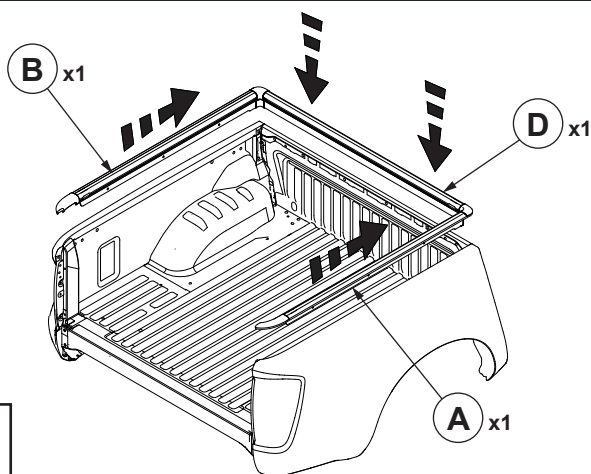

6

APPLY DOWNWARD PRESSURE & TIGHTEN FRONT BOLTS

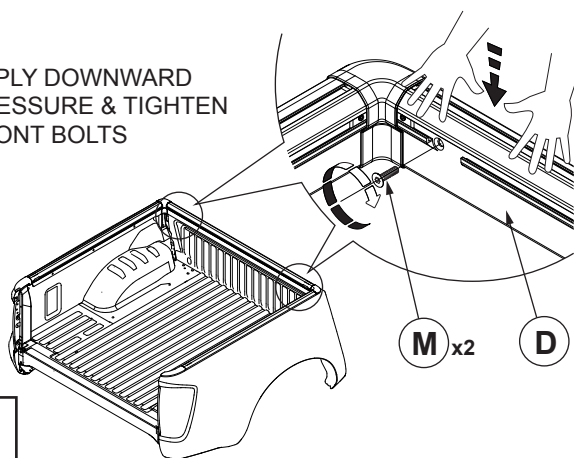

7

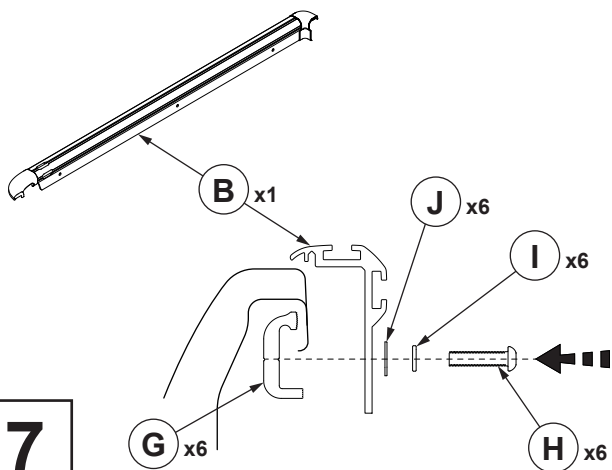

8

FINGER TIGHTEN ALL SIX BOLTS LOOSELY

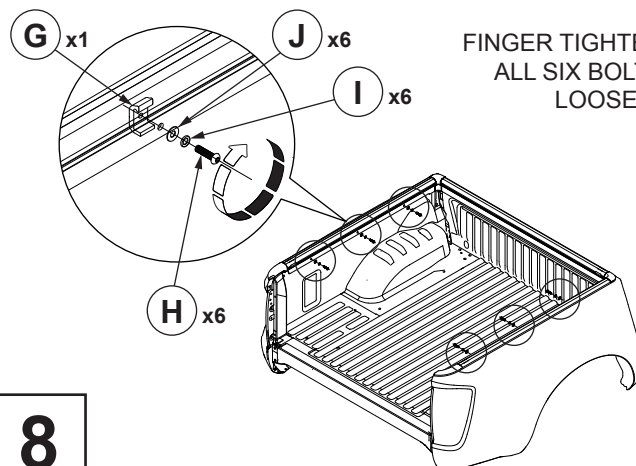

Fitting Kit Number	Manufacturer	Model Type	Year	Stockist	Cab Size	Product	Revision	Date	Page
K439	Ford/Mazda	Ranger/BT50	2011	-	DC	TANGO	3	24/7/2016	2 of 4

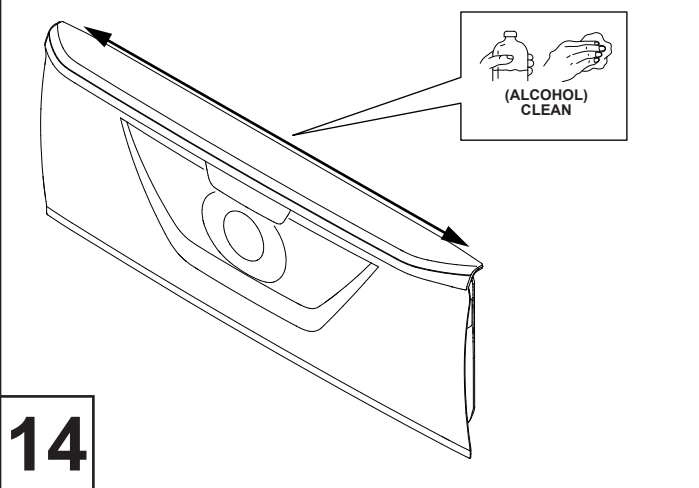
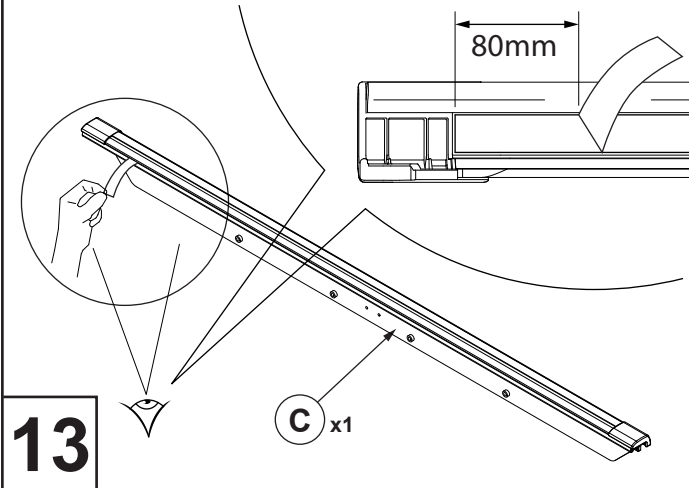
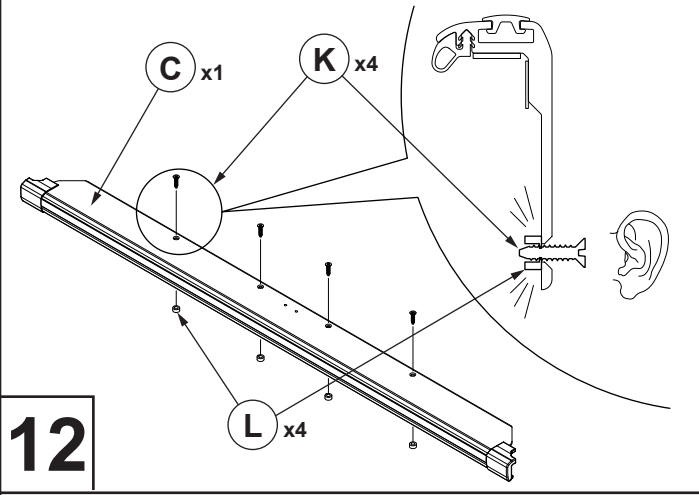
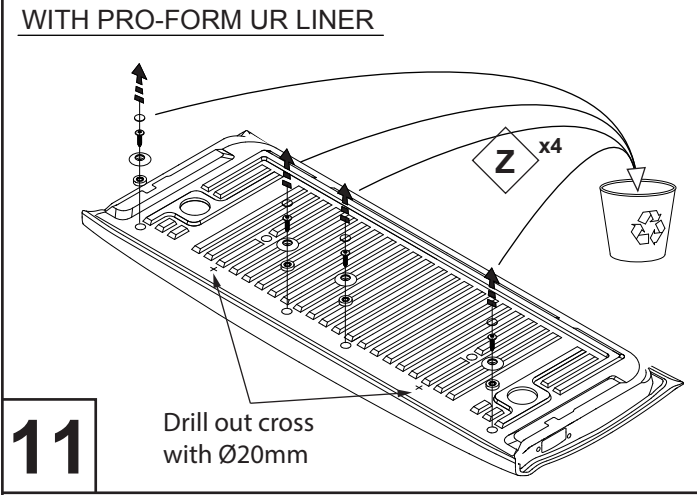
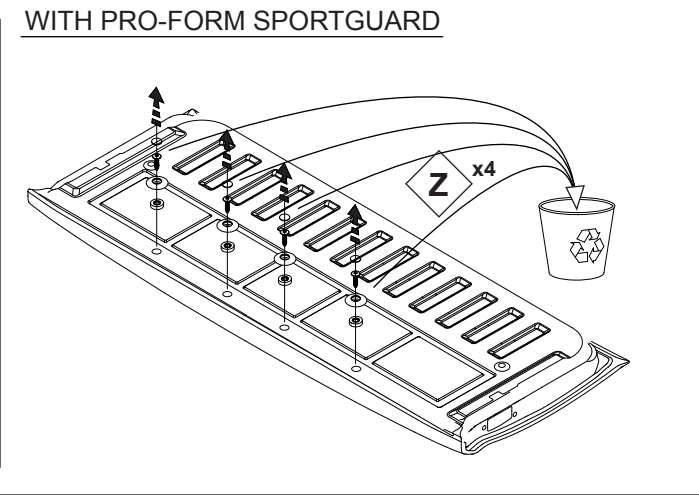
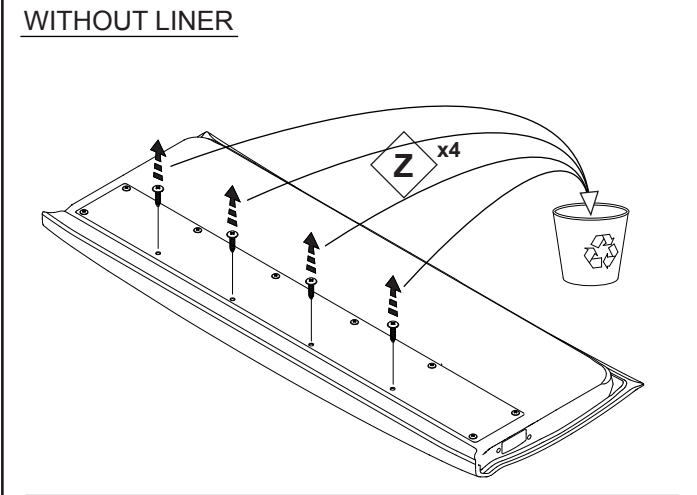
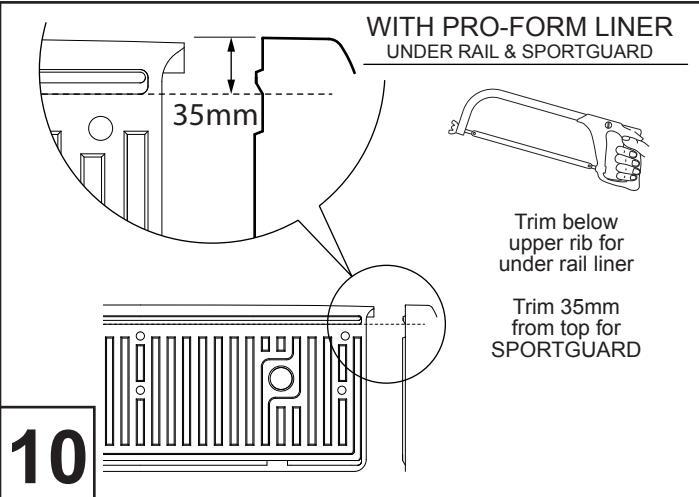
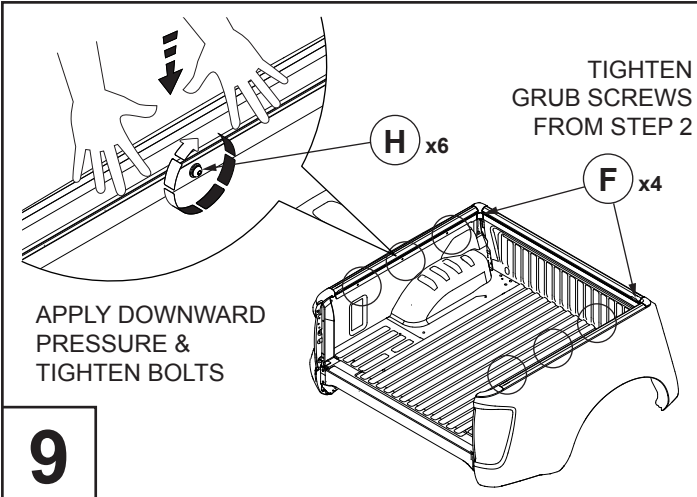

Fitting Kit Number	Manufacturer	Model Type	Year	Stockist	Cab Size	Product	Revision	Date	Page
K439	Ford/Mazda	Ranger/BT50	2011	-	DC	TANGO	3	24/7/2016	3 of 4

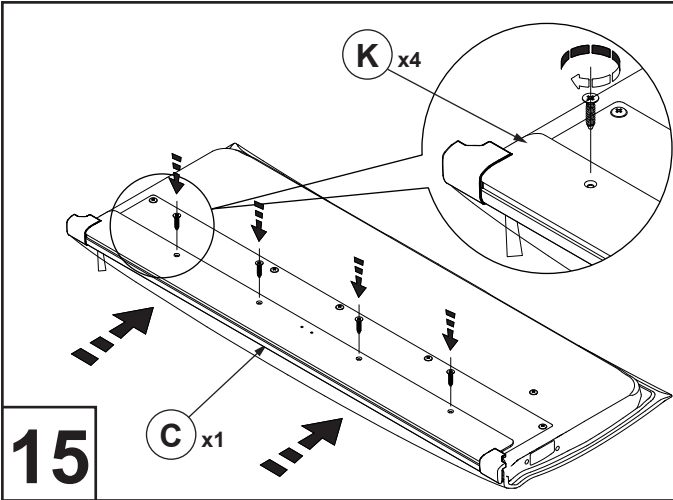

15

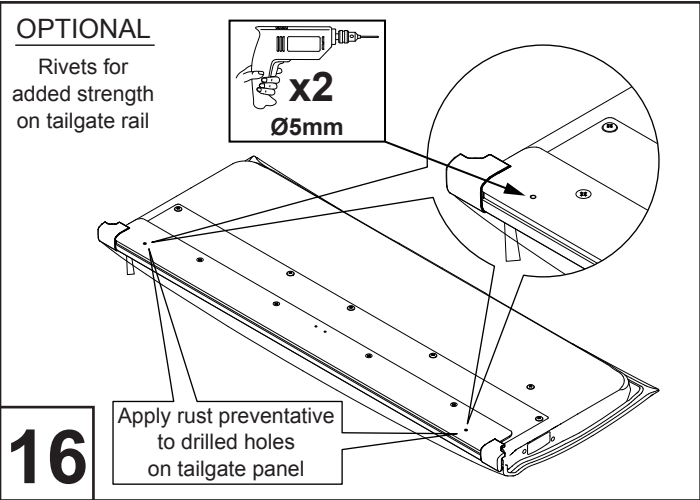

16

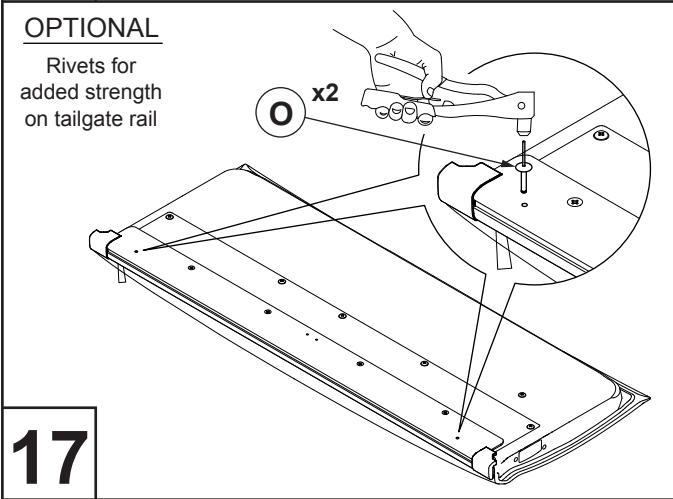

17

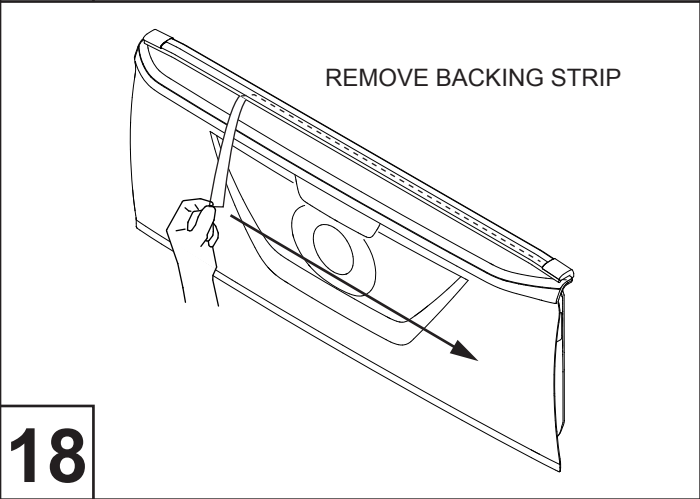

18

Fitting Kit Number	Manufacturer	Model Type	Year	Stockist	Cab Size	Product	Revision	Date	Page
K439	Ford/Mazda	Ranger/BT50	2011	-	DC	TANGO	3	24/7/2016	4 of 4